

NSCM (NEWTON STEEL CABLE MANAGEMENT)

Modified:12/11/2013

Follow the steps below to complete your 12 Character ordering number

NSCM **A** **A** **A** **B** **B** **B** **X** **X**

NSCM	AAA	BBB	XX
Newton Steel Cable Management		XX: FINISH CODE 30 = Telco Gray 47 = Black	
AAA: OVERALL HEIGHT 012 = 1'-0" height (extension for 072 or 084) 024 = 2'-0" height (extension for 072 or 084) 072 = 6'-0" height 084 = 7'-0" height 096 = 8'-0" height 108 = 9'-0" height Other heights available, call your CSR		BBB: WIDTH OF CABLING SECTION 361 = single sided, outside width dimension of 3.65" 601 = single sided, outside width dimension of 6.00" 101 = single sided, outside width dimension of 10.00" 365 = double sided, outside width dimension of 3.65" 600 = double sided, outside width dimension of 6.00" 100 = double sided, outside width dimension of 10.00"	

Note:

- Designed to mount on **NEWTON UNEQUAL AND EQUAL FLANGE RACKS.**

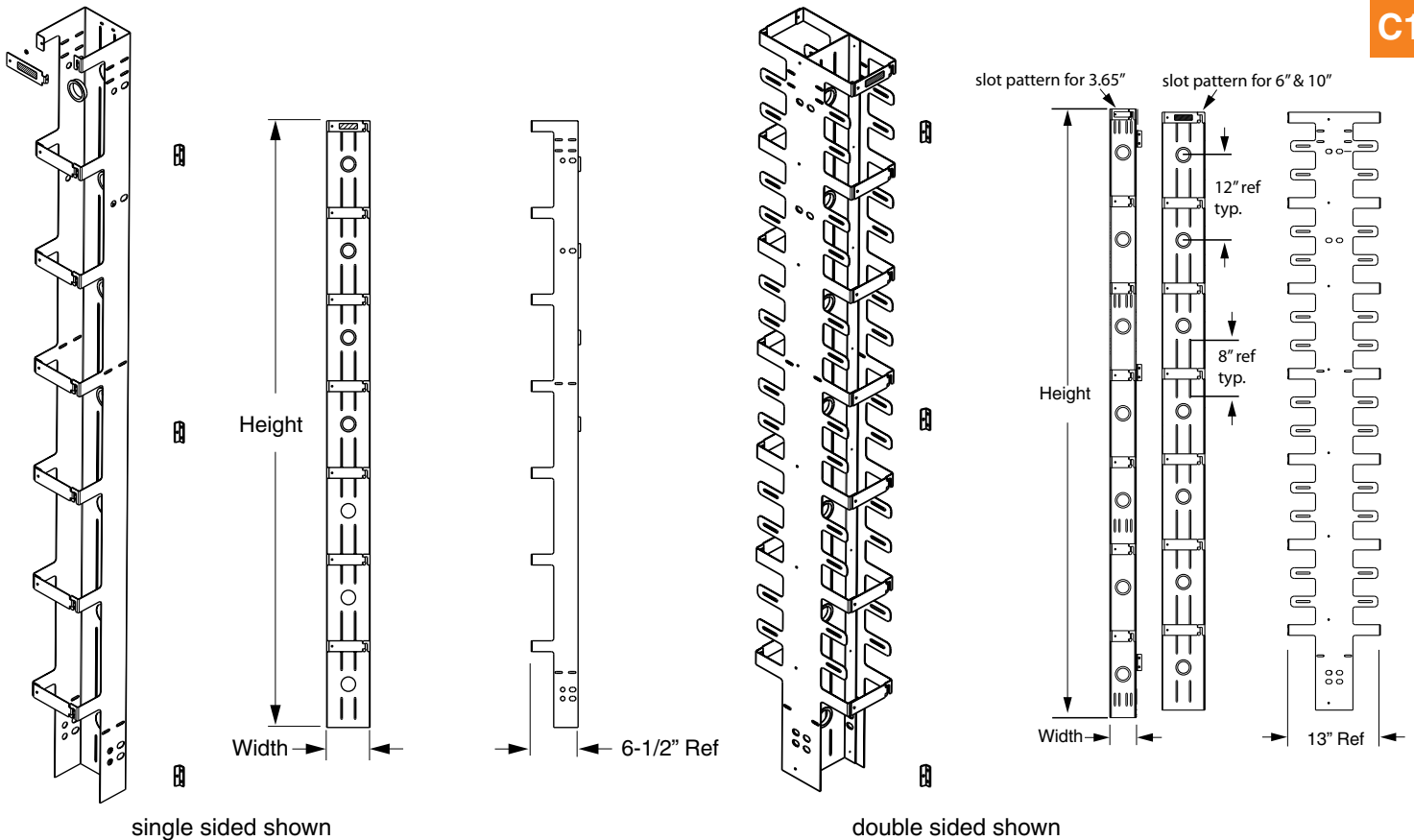

C11

NEWTON UNEQUAL FLANGE CABLING SECTION (ALUMINUM)

Modified:04/29/2010

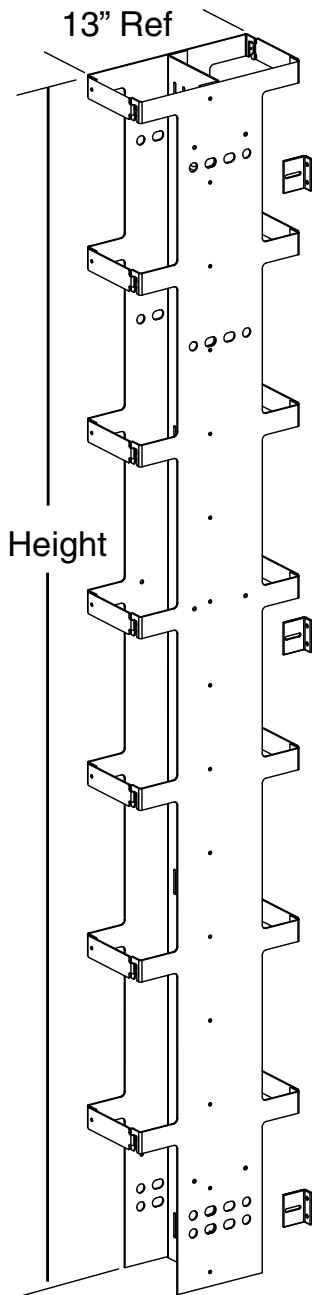

Newton Unequal flange Cabling Section (NUCS) systems offer space-saving, high quality, and lightweight cable management options. They are double-sided, mount between “unequal flange” and “netbay” equipment racks and all edges are protected against possible cable wear and abrasion. Available in narrow (3.65”) And wide (6.00”) Widths.

Follow the steps below to complete your 12 Character ordering number

NUCS	AAA	BBB	XX
Newton Unequal Flange Cabling Section			XX: FINISH CODE 23 = GRAY 30 = TELCO GRAY 47 = BLACK
AAA: OVERALL HEIGHT 084= 84” height 096= 96” height		BBB: WIDTH OF CABLING SECTION 365 = outside width dimension of 3.65”; 600 = outside width dimension of 6.00”;	

C11

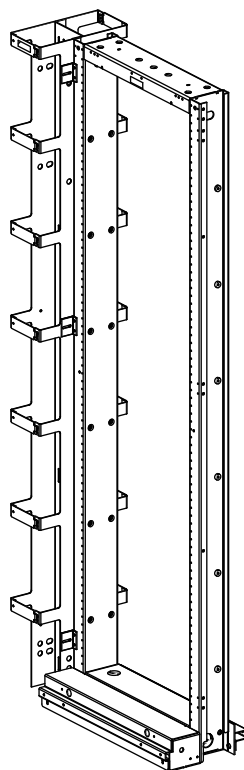
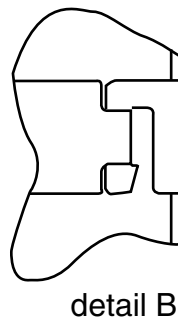
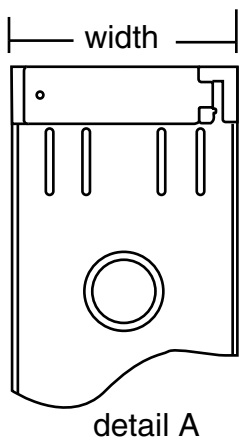

Features

- Sturdy, lightweight aluminum construction
- Four sets of vertical slots for use with cable/zip ties for organized, bundled cables (see Detail “A”)
- Seven cable and wiring pass-through holes (1” diameter) with edge protection (see Detail “A”)
- Positive-locking rotating latches every 12” (see Detail “B”)
- Plastic grommeting provided on all edges ensures cables and wires are protected (on unfinished units only)
- Approximate weight of 84” (7’-0”) unit is 15 pounds
- Mounting hardware included with every unit

CABLEWAY ASSEMBLY

Modified:09/22/2009

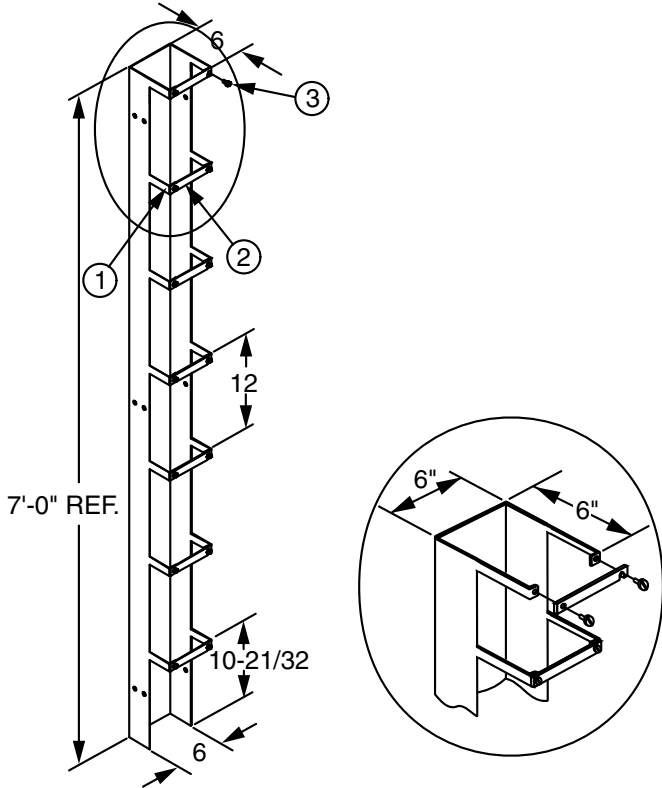

Part Number	
Ordering	21254900xx

Stock List		
Item	Qty	Description
1	1	cableway
2	7	cross bar
3	14	thumb screw 1/4"-20

- Notes:**
- XX = finish code; standard finish, xx= 30.
 - Material = aluminum.

NVCM (NEWTON VERTICAL CABLE MANAGEMENT) - ALUMINUM

Modified:10/16/2009

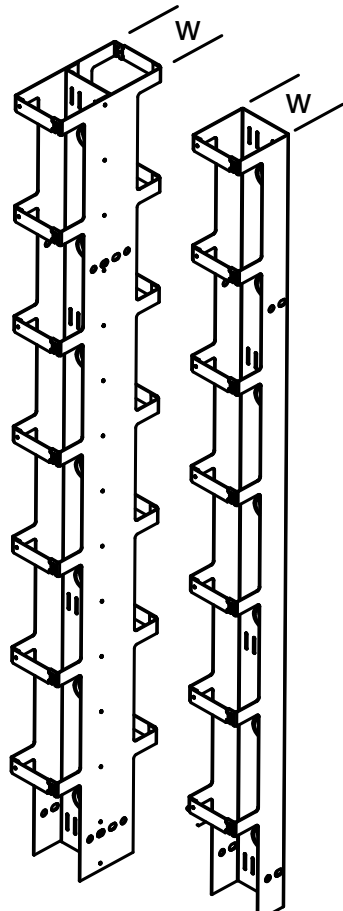

Follow the steps below to complete your 12 Character ordering number

NVCM	AAA	BBB	XX
Newton Vertical Cable Management	AAA: OVERALL HEIGHT 084 = 84" height 096 = 96" height	BBB: WIDTH OF CABLING SECTION 361= single sided, outside width dimension of 3.65"; 601 = single sided, outside width dimension of 6.00"; 365 = double sided, outside width dimension of 3.65"; 600 = double sided, outside width dimension of 6.00";	XX: FINISH CODE 23 = GRAY 30 = Telco Gray 47 = Black

C11

CABLE MANAGER SPACER BOX FOR NETWORK BAY

Modified:06/25/2015

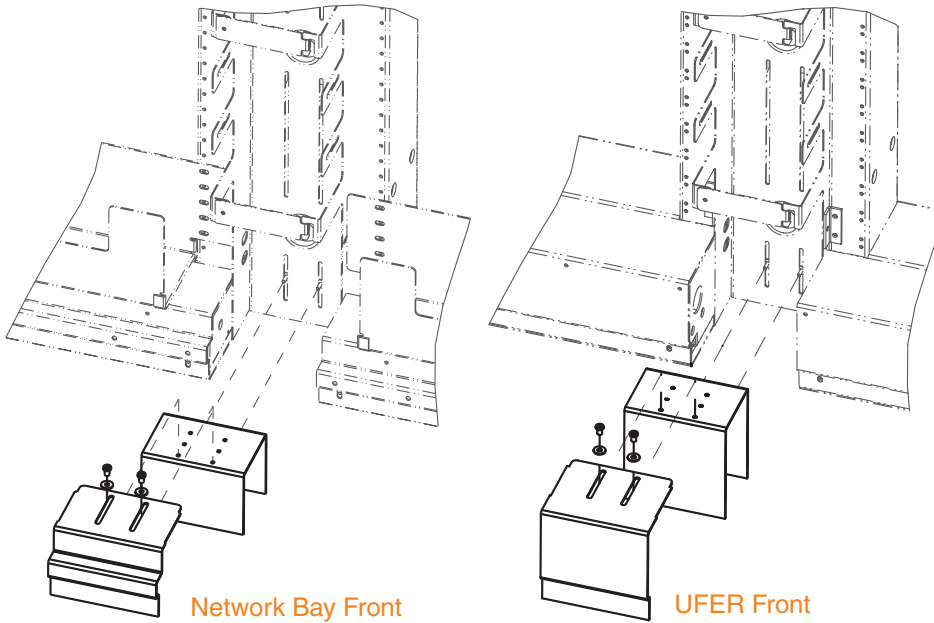

Ordering Table

Part Number	Rack	Width
22244802xx	Network Bay	6"
22420702xx	UFER	6"

Stock List

Item	QTY	Description
1	2	#8 Flat Washer
2	2	#12 Flat Washer
3	2	12-24 X 3/8" PHMS
4	2	#-32 X 1/2" PHMS
5	1	Cable Manager Spacer Support
6	1	Cable Manager Spacer Panel

C11 NETWORK BAY DUCT COVER WITH WIRE MANAGEMENT

Sales Sheet Modified:09/22/2016

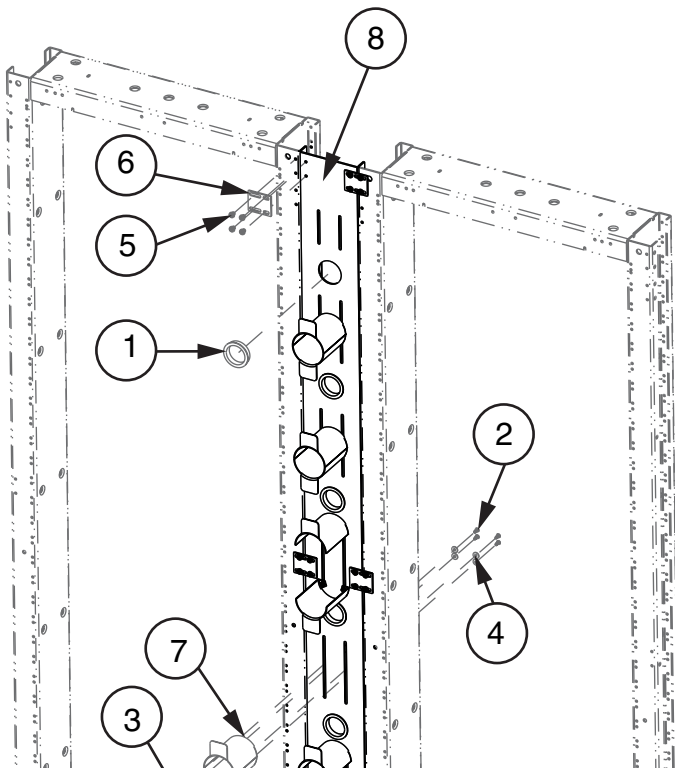

Ordering Table

Part Number	Rack Height	A
22231501xx	7'-0"	5"
22231503xx	8'-0"	3"
22231601xx	7'-0"	10"

Stock List

Item	QTY	Description
1	7	Snap Bushing
2	24	8-32 X 3/8 RHMS
3	24	8-32 Hex Nut
4	24	#8 Flat Washer
5	24	12-24 X 1/4 PHMS
6	6	Junction Plate
7	12	Cable Manager Spool
8	1	NetBay End Cover Extension

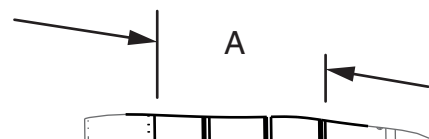

CABLING SECTION FOR 3" CHANNEL RACK

Modified:05/23/2013

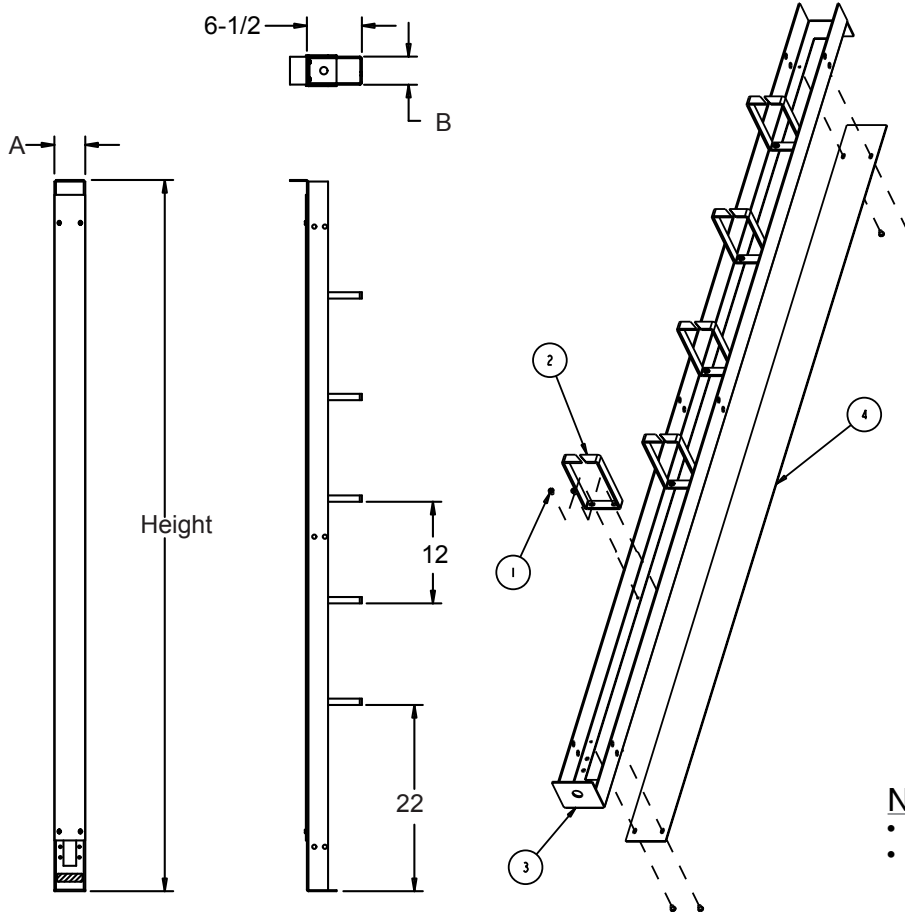

	part number	Height	A	B
Ordering Table	21702201xx	7'-0"	6"	5"
	21702202xx	7'-6"	6"	5"
	21702203xx	8'-0"	6"	5"
	21702204xx	9'-0"	6"	5"
	21702205xx	11'-6"	6"	5"
	21702206xx	11'-8"	6"	5"
	21702251xx	7'-0"	3-5/8"	3-5/16"
	21634301xx	7'-0"	8"	7"
	21634302xx	7'-6"	8"	7"
	21634303xx	8'-0"	8"	7"
	21634304xx	9'-0"	8"	7"
	21634305xx	11'-6"	8"	7"
21634306xx	11'-8"	8"	7"	

	item	qty.	description
Stock List	1	AR	12-24 x 5/16 phms
	2	AR	D-ring
	3	1	cable trough
	4	1	cabling section cover

Notes:

- Finish is TE gray, finish code 30
- Steel

UFER CABLING SECTION

Modified:09/28/2009

C11

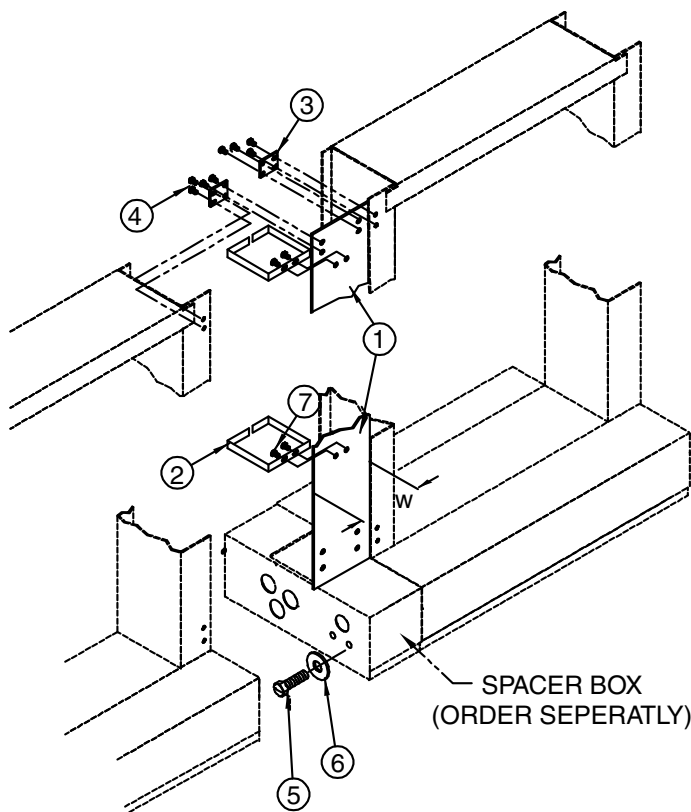

	part number	W	Rack Height
Ordering	21719701xx	5"	7'-0"
	21719704xx	5"	9'-0"
	21719705xx	5"	10'-0"
	21719707xx	5"	11'-6"

	Item	Qty	Description
Stock List	1	1	Cover
	2	ar	D-Ring
	3	ar	Junction Plate
	4	ar	12-24 X 1/4 Phms
	5	4	3/8-16 X 5/8" Hhcs
	6	4	3/8" Flatwasher
	7	ar	12-24 X 5/16 Phms

CABLING SECTION

Modified:03/22/2010

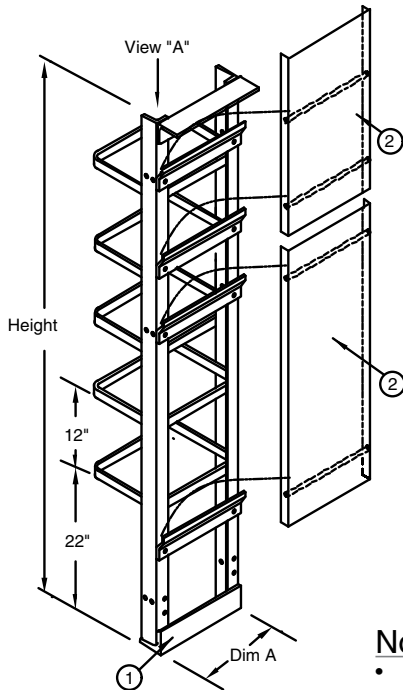
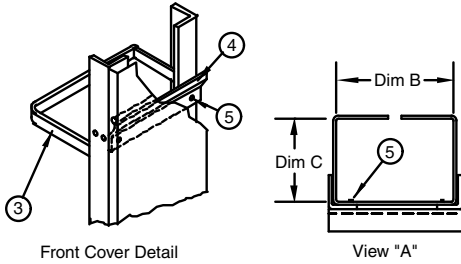

	Ordering Table					
	part number	height	A	B	C	stock list
00404901xx	7'-0"	6	5	6	1	
00404902xx	7'-6"	6	5	6	2	
00404903xx	8'-0"	6	5	6	3	
00404904xx	9'-0"	6	5	6	4	
00404905xx	11'-6"	6	5	6	5	
00404906xx	11'-8"	6	5	6	6	
21118101xx	8'-8"	6	5	6	7	
21118102xx	9'-6"	6	5	6	8	
21118103xx	10'-0"	6	5	6	9	
21118104xx	6'-6"	6	5	6	10	
21118105xx	11'-0"	6	5	6	11	
00405001xx	7'-0"	8	7"	6-1/2"	1	
00405002xx	7'-6"	8	7"	6-1/2"	2	
00405003xx	8'-0"	8	7"	6-1/2"	3	
00405004xx	9'-0"	8	7"	6-1/2"	4	
00405005xx	11'-6"	8	7"	6-1/2"	5	
00405006xx	11'-8"	8	7"	6-1/2"	6	

Item	Description	stock list										
		1	2	3	4	5	6	7	8	9	10	11
1	cable trough	1	1	1	1	1	1	1	1	1	1	1
2	cover	1	1	1	2	2	2	1	2	2	1	2
3	"D" ring	6	6	6	7	10	10	7	7	8	5	9
4	cover mounting clip	2	2	2	4	4	4	2	4	4	2	4
5	12-24 x 7/16" phms	14	16	16	22	28	28	18	22	24	14	26

Notes:

- XX= finish code; standard finish, xx= 30.
- Order accessories as required.
- Unless otherwise specified, cabling sections will be supplied with materials shown on stock list.
- Holes in side of cabling section are for joining to rack or for mounting ladder end guards.
- Special widths and heights available on request.
- Steel

CABLE MANAGEMENT SPOOLS

Sales Sheet Modified:08/19/2016

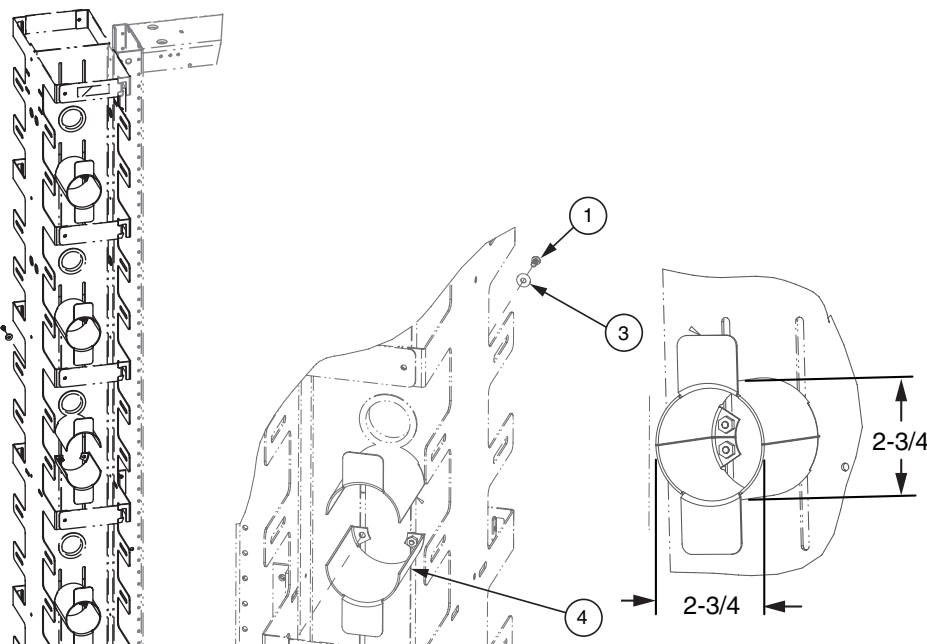

Ordering Table

Part Number	Kit QTY
22232700xx	1
22232701xx	6

Stock List

Item	QTY	Description
1	AR	#8-32 x 5/16" RHMS
2	AR	8-32 Hex Nut
3	AR	#8 Flat Washer
4	AR	Cable Manager Spool

HORIZONTAL ADJUSTABLE RACKMOUNT MANAGEMENT KIT

Modified:08/19/2016

Description: Used as a slack manger for fiber and copper cabling on equipment racks

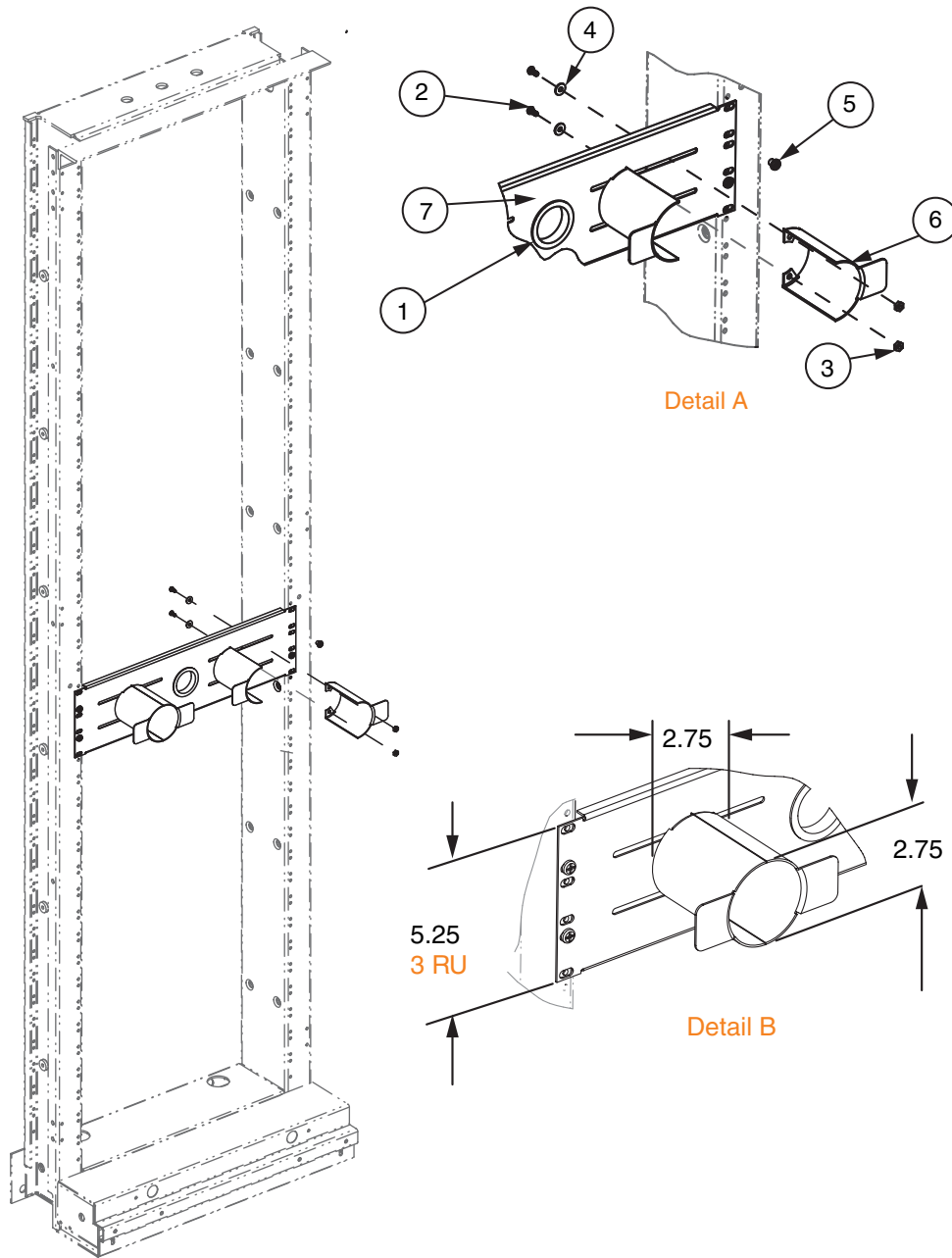

Ordering Table

Part Number	Mtg. Width
22233001xx	19"
22233002xx	23"

Stock List

Item	QTY	Description
1	1	Snap Bushing
2	8	#8-32 x 5/16" RHMS
3	8	8-32 Hex Nut
4	8	#8 Flat Washer
5	4	12-24 x 1/4" PHMS
6	4	Cable Manager Spool
7	1	Horizontal Cable Manager Panel

C11

WIRE MANAGEMENT PANEL KIT

Modified:02/04/2015

Description: Wire management panel with bolt on D-Rings for managing Fiber or Copper Cables

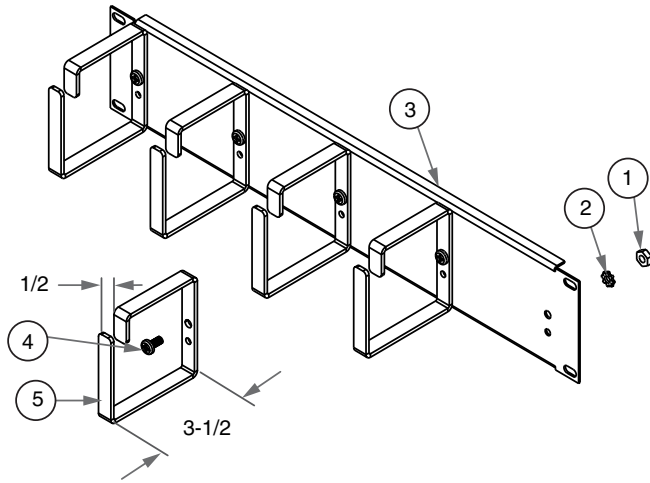

Ordering Table

Part Number	Rack
22180101xx	19"
22180102xx	23"

Stock List

Item	QTY	Description
1	AR	12-24 Hex Nut
2	AR	#12 External tooth washer
3	1	Wire management panel
4	AR	12-24 X 1/2" PHMS
5	AR	3-1/2" x 3-1/2" D-ring

WIRE MANAGEMENT PANEL KIT WITH SPOOLS

Description: Wire management panel with bolt on D-Rings and Spools for managing Fiber or Copper Cables

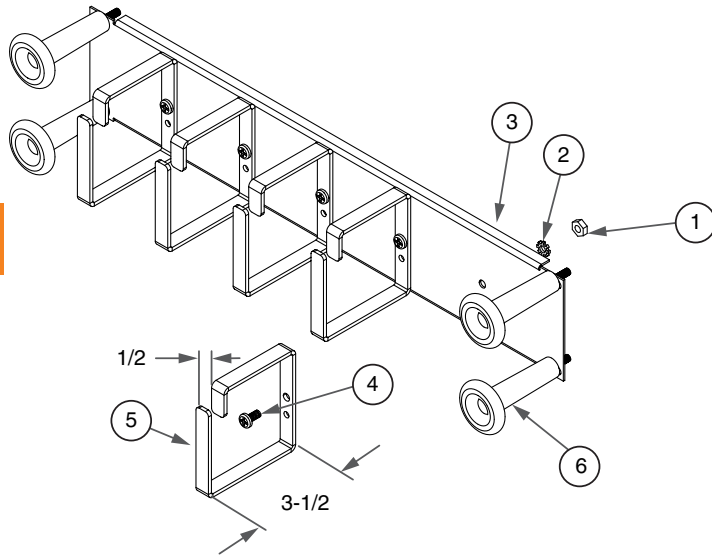

Ordering Table

Part Number	Rack
22180151xx	19"
22180152xx	23"

Stock List

Item	QTY	Description
1	AR	12-24 Hex Nut
2	AR	#12 External Tooth Washer
3	1	Wire Management Panel
4	AR	12-24 X 1/2" PHMS
5	AR	3-1/2" X 3-1/2" D-Ring
6	4	Distribution spool

C11

1 RU CABLE MANAGER WITH SPOOLS

Description: 1 Rack Unit wire management panel with spools for managing Fiber or Copper Cables

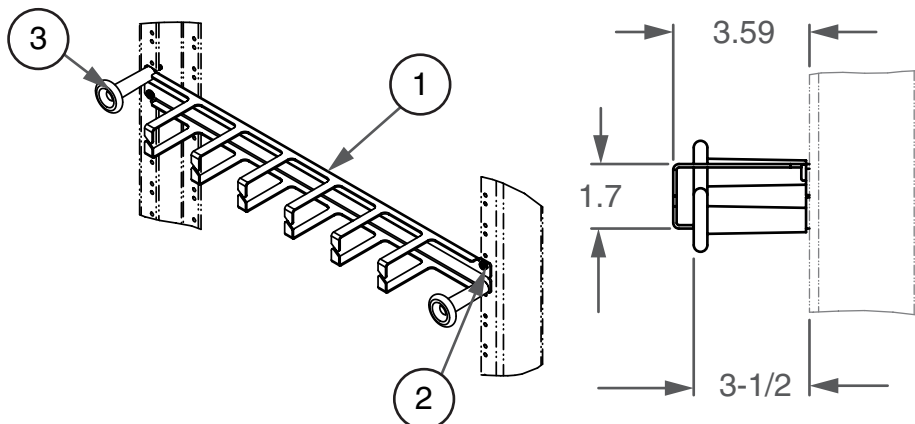

Ordering Table

Part Number	Rack
22180181xx	19"
22180182xx	23"

Stock List

Item	QTY	Description
1	1	1 Ru Wire Management Panel
2	2	12-24 X 1/2" PHMS
3	2	Distribution Spool

WIRE MANAGEMENT PANEL

Modified:10/01/2009

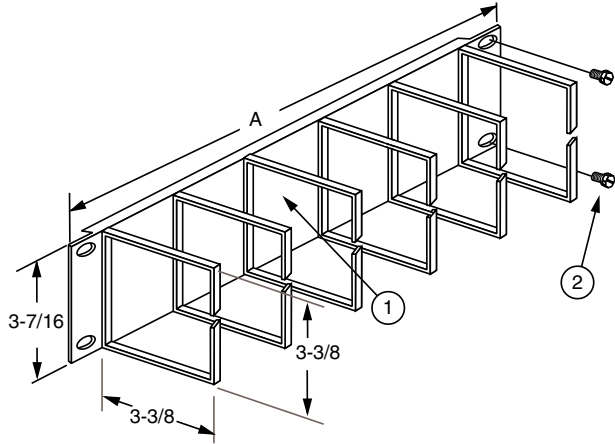

		Part Number	A
Ordering		00413401xx	19
		00413402xx	23

		Item	Qty	Description
Stock List		1	1	wire management panel
		2	4	12-24 x 1/2" tri-lobe screw

Notes:

- XX= finish code; standard finish, xx= 30.

WIRE MANAGEMENT PANEL

Modified:10/01/2009

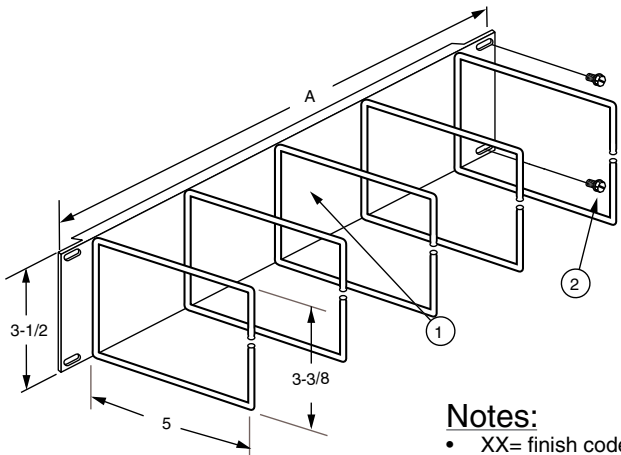

		Part Number	A
Ordering		00413501xx	18-5/16"
		00413502xx	22-5/16"

		Item	Qty	Description
Stock List		1	1	wire management panel
		2	4	12-24 x 1/2" psts

C11

Notes:

- XX= finish code; standard finish, xx= 30.

WIRE MANAGEMENT PANEL, 19"

Modified:10/01/2009

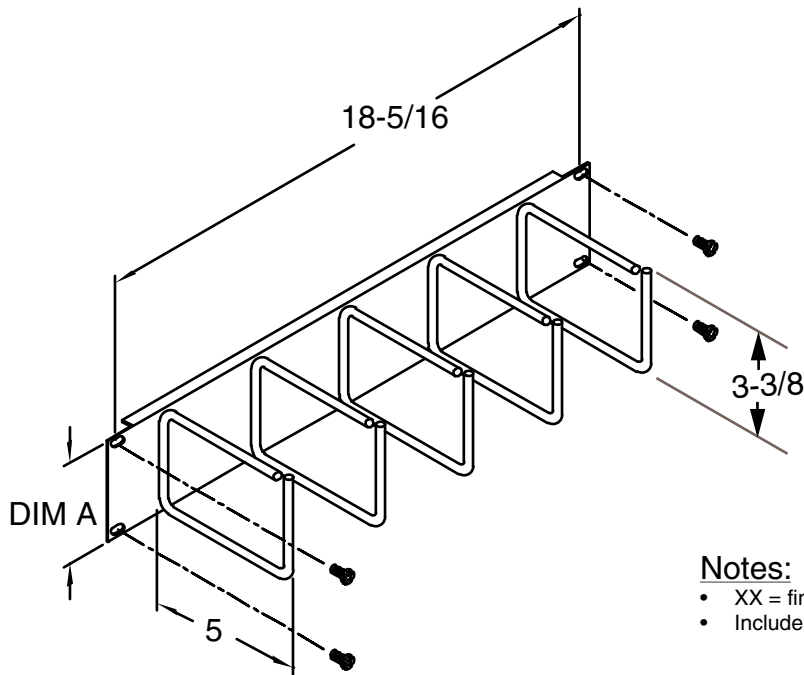

		Part Number	A	Rack Width
Ordering		21440901xx	3-7/16"	
		21440902xx	6-7/8"	

Notes:

- XX = finish code; standard finish, xx = 30.
- Includes four 12-24 x 1/2" pan head stainless steel mounting screws.

WIRE MANAGEMENT PANEL, 19"

Modified:03/12/2013

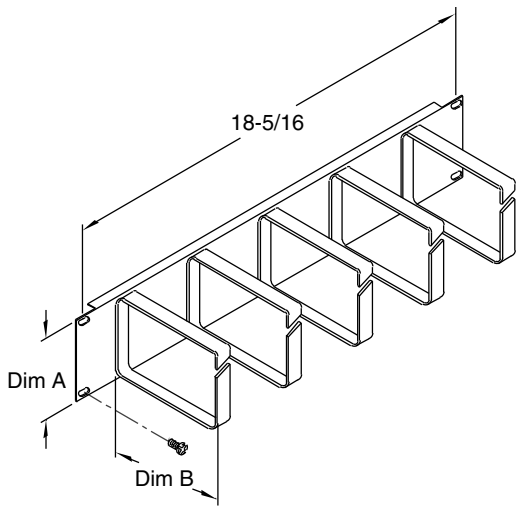

	Part Number	A	B
Ordering	21318200xx	6-7/8"	8
	21318300xx	3-11/32"	5

Notes:

- XX = finish code; standard finish, xx = 30.
- Includes four 12-24 x 1/2" pan head stainless steel mounting screws.

WIRE MANAGEMENT PANEL

Modified:10/01/2009

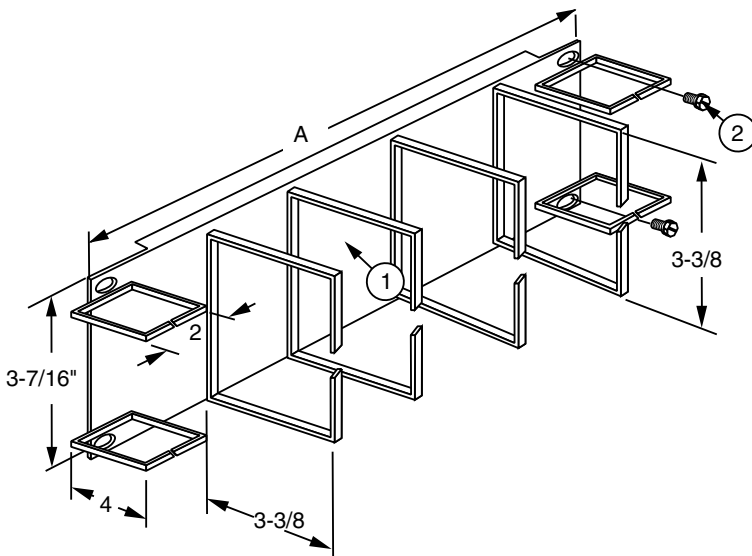

	Part Number	A
Ordering	00412901xx	19
	00412902xx	23

	Item	Qty	Description
Stock List	1	1	wire management panel
	2	4	12-24 x 1/2" tri-lobe screw

Notes:

- XX= finish code; standard finish, xx= 30.

CABLE TROUGH

Modified:07/02/2013

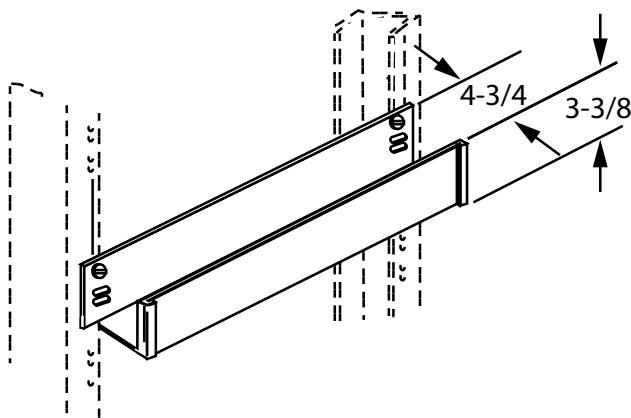

	part number	rack
Ordering	00406300xx	19"
	00406400xx	23"

1 RU TOP TROUGH KIT

Sales Sheet Modified:10/12/2016

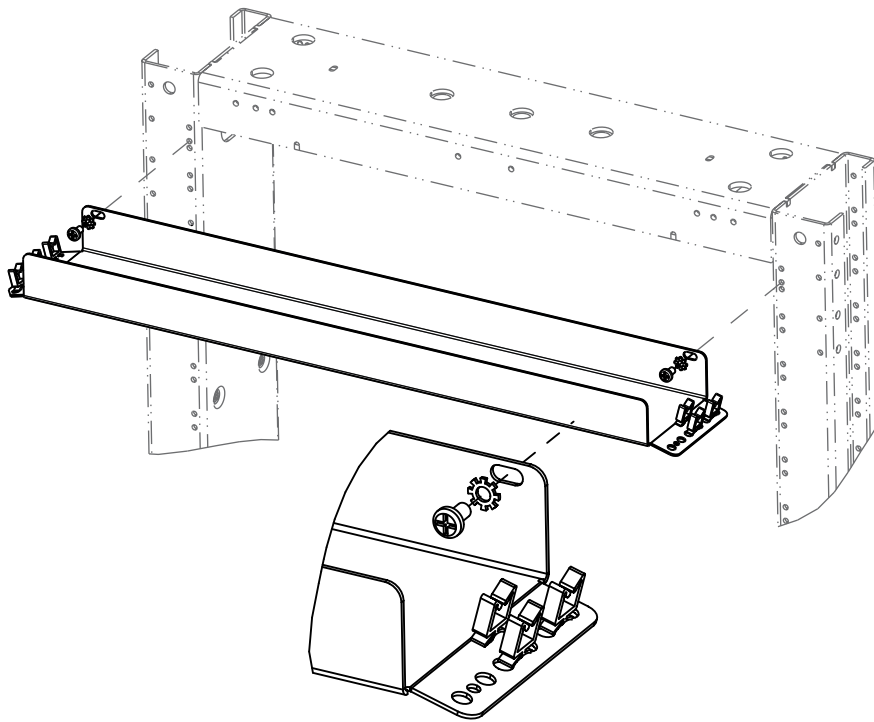

Detail A

Ordering Table

Part Number	Rack
22433001xx	19"
22433002xx	23"

Stock List

Item	QTY	Description
1	6	Wire Retaining Clip
2	2	120-24 x 3/8 PHMS
3	2	#12 External Tooth Washer
4	1	Cable Trough with 15°

Notes:

- xx represents the finish code. Select color before ordering

1 RU BOTTOM TROUGH KIT

Sales Sheet Modified:11/15/2016

C11

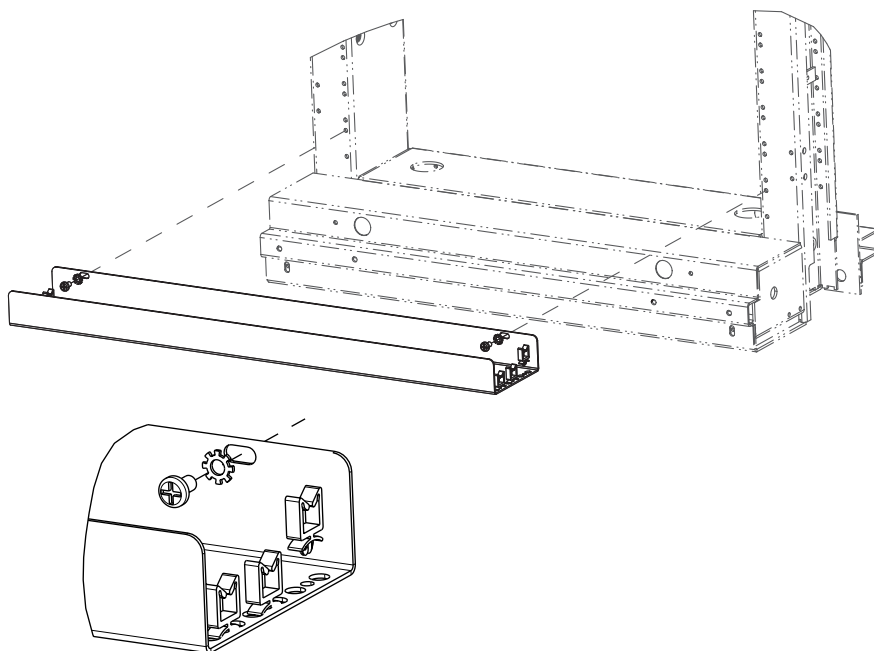

Detail A

Ordering Table

Part Number	Rack
22433101xx	19"
22433102xx	23"

Stock List

Item	QTY	Description
1	6	Wire Retaining Clip
2	2	120-24 x 3/8 PHMS
3	2	#12 External Tooth Washer
4	1	Cable Trough

Notes:

- xx represents the finish code. Select color before ordering

CABLE TIE BAR FOR UNEQUAL FLANGE AND NETBAY EQUIPMENT RACK

Modified:09/22/2015

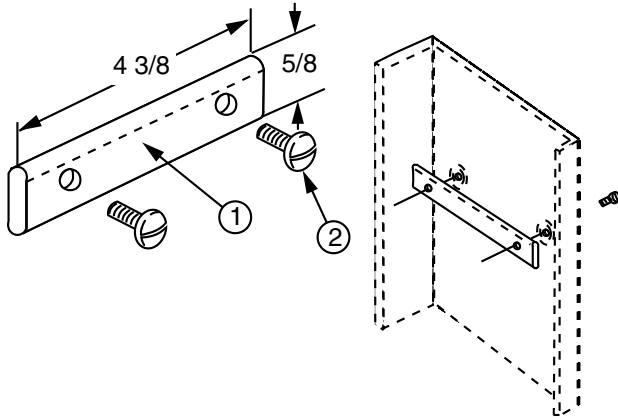

	part number	kit for rack	stocklist
Ordering Table	0041190110	7'-0" or 7'-6"	1
	0041190210	8'-0"	2
	0041190310	9'-0"	3
	0041190410	11'-6" or 11'-8"	4

		Stock List				
Item	Description	1	2	3	4	
Stock List	1	cable clamp bar	12	14	16	20
	2	8-32 x 1/4" phms	24	28	32	40

Notes:

- 1. Finish is zinc plated and gold chromate.

CABLE BRACKET

Sales Sheet Modified:10/12/2016

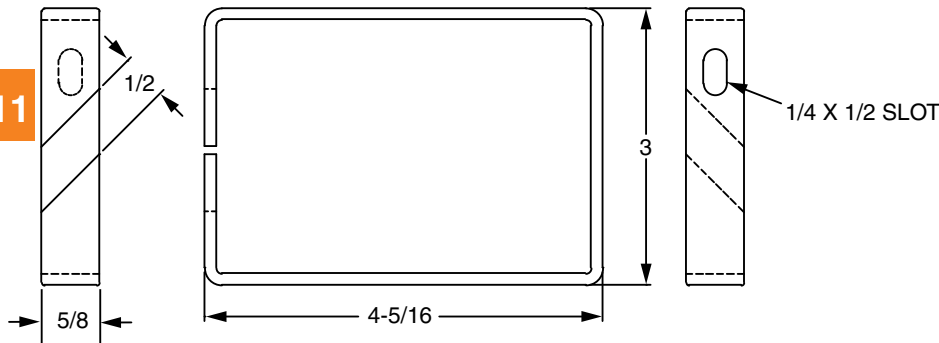

Ordering Table

Part Number

21317800XX

Notes:

- XX = finish code; standard finish, xx= 30.

CABLE BRACKET

Modified:10/01/2009

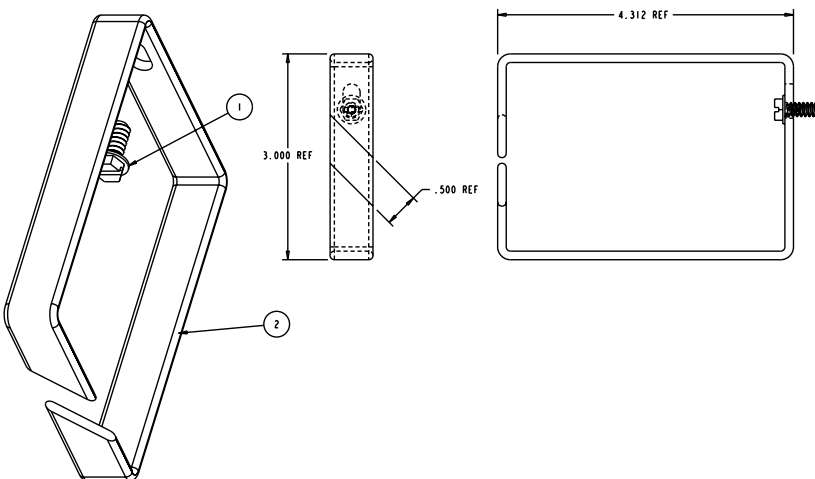

	part number
Ordering	22107200xx

	Item	Qty	Description
Stock List	1	1	12-24 x 1/2" tri-lobe screw
	2	1	cable bracket

SINGLE CABLE RING KIT

Sales Sheet Modified:03/09/2017

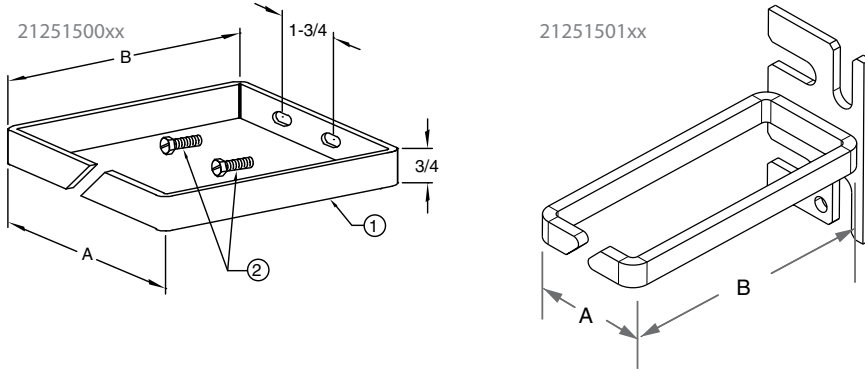

Ordering Table

Part Number	A	B
21251500xx	4"	5"
21251501xx	1-1/4"	3"

WIRE MANAGEMENT RACK KIT

Sales Sheet Modified:10/12/2016

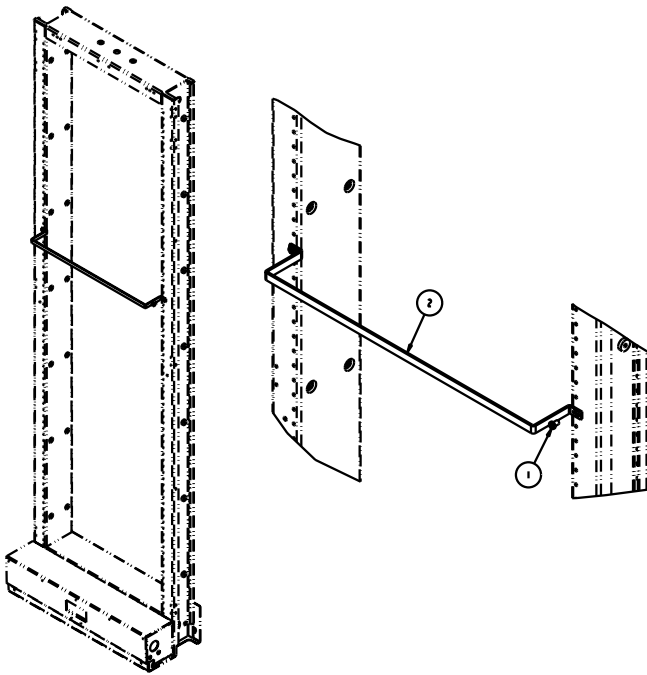

Ordering Table

Part Number	Depth	Rack Width
22054453xx	5"	19"
22054454xx	8"	19"
22152500xx	4"	19"
22152600xx	2"	19"
22152602xx	0"	19"
22152700xx	6"	19"
2205445730	10	19"
22054401xx	3"	23"
22054402xx	4"	23"
22054403xx	5"	23"
22054404xx	8"	23"
22054405xx	2"	23"
22054406xx	6"	23"
22054407xx	10"	23"
22152601xx	0"	23"

C11

Stock List

Item	QTY	Description
1	2	12-24 PHMS
2	1	Wire Rack

ADJUSTABLE WIRE MANAGEMENT RACK KIT

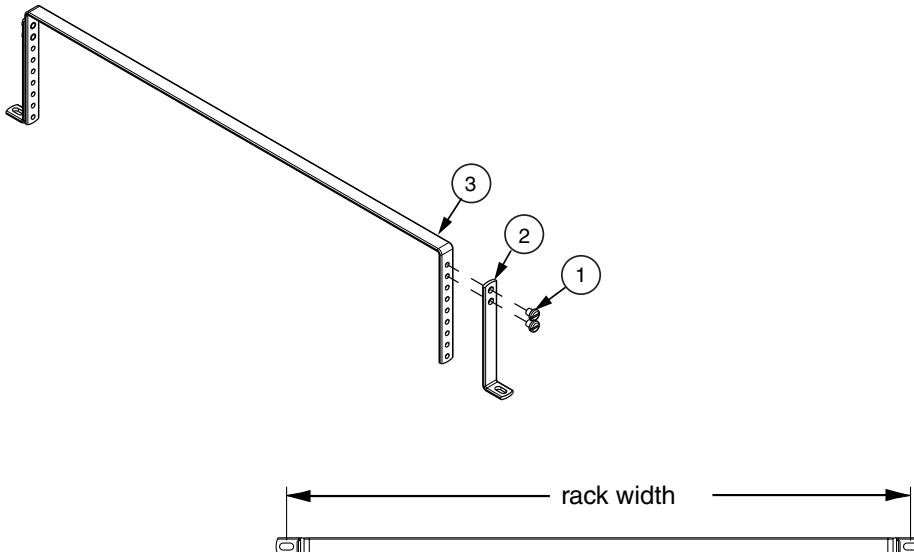

Ordering Table

Part Number	Depth	Rack Width
22054409xx	5"-8.5"	23"
22054459xx	5"-8.5"	19"
22054410xx	3"-4.5"	23"
22054460xx	3"-4.5"	19"

Stock List

Item	QTY	Description
1	4	12-24 phms
2	2	"L" bracket
3	1	"U" strap

CABLE TIE BRACKET KIT

Modified:10/08/2009

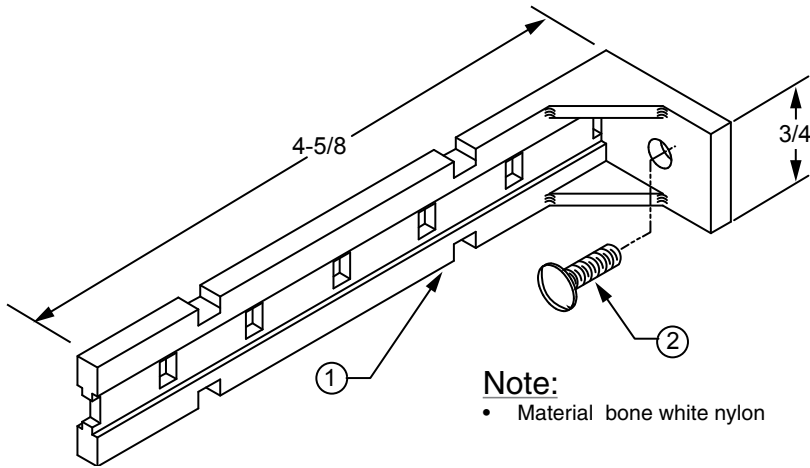

part number	
Ordering Table	2103050000

Stock List		
Item	Qty	Description
1	1	Bracket
2	2	10-32 x 1/2 nylon rhms

FANNING STRIP

Modified:09/25/2009

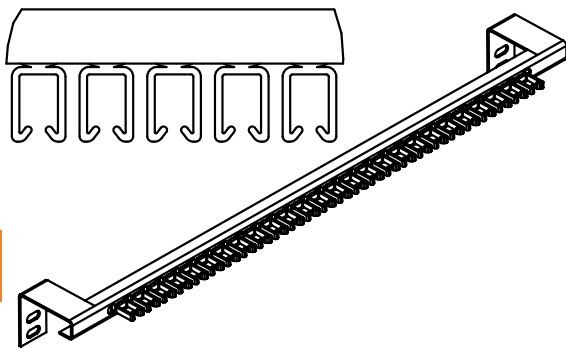

part number			rack	clips
Ordering	00406500xx	19"	20	
	00406600xx	23"	26	

C11

CABLE BRACKET

Sales Sheet Modified:09/09/2015

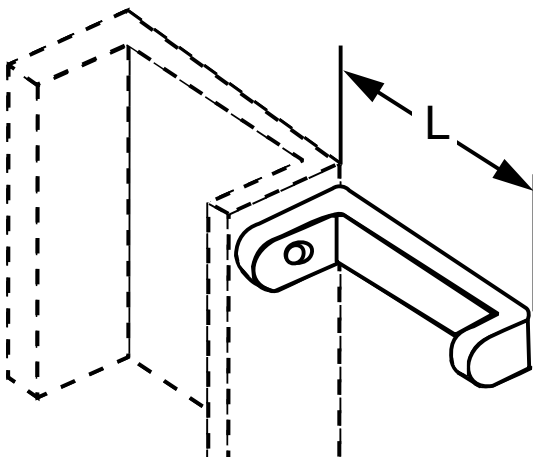

Ordering Table

Part Number	L
00404101xx	2
00404102xx	3
00404103xx	4
00404104xx	5
00404105xx	6
00404106xx	7
00404107xx	8
00404108xx	9
00404109xx	10
00404110xx	12
00404111xx	14
00404112xx	16

12" LGX FOT RACK KIT

Modified:09/23/2009

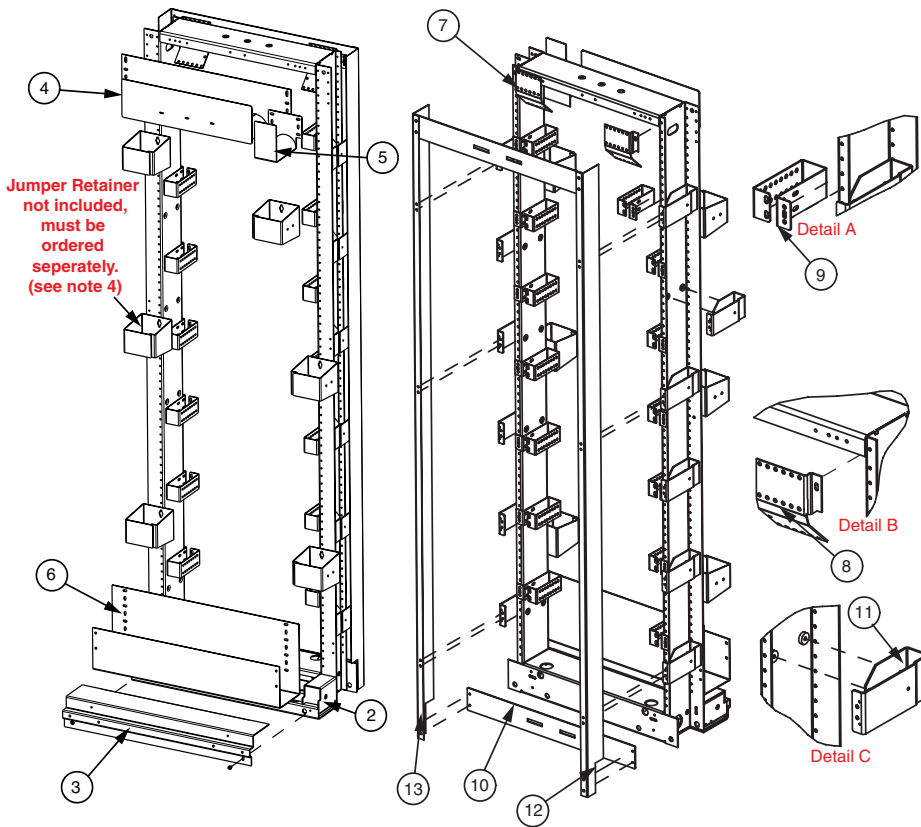

	part number	foot print
Ordering Table	2223460064	12"

	Item	Qty	Description
Stock List	1	1	fiber cable management kit
	2	1	7' x 23" netbay, closed, 1" mtg.
	3	1	5" front guard rail kit
	4	1	upper raceway
	5	1	jumper support
	6	1	lower raceway
	7	1	cable retainer bracket , left
	8	1	cable retainer bracket , right
	9	14	LGX 12" cable retainer bracket
	10	2	LGX frame brace
	11	12	LGX 6.5" duct bracket
	12	1	side panel, left side
	13	1	side panel, right side

Assembly Notes:

1. Install front guard rail cover (**Item 3**) to front of rack using the (2) 12-24 x 3/8 tri-lobe screws found in the kit as shown in the picture.
2. Install the lower raceway (**Item 6**) using 6 (3 ea. side) 12-24 x 3/8 pan head machine screws found in hardware kit (**Item 1**) as shown in the picture.
3. Install the upper raceway (**Item 4**) using 6 (3 ea. side) 12-24 x 3/8 pan head machine screws found in hardware kit (**Item 1**) as shown in the picture. The jumper support (**Item 5**) can be installed as an extension to the upper raceway.
4. The jumper retainers (part #, **single shown 21231300xx, double 21231302xx**) must be ordered separately as an accessory item. If ordered, install the jumper retainers using (2) 12-24 x 3/8 pan head machine screws as shown in the picture. The jumper retainers can be installed in any location using the mtg. Holes on the rack (the picture is just an example).
5. Install the left & right cable retainer bracket assemblies (**Items 7 & 8**) to the rack using 4 (2 ea. side) 12-24 x 3/8 pan head machine screws found in hardware kit (**part # 2126490110**) as shown in (**Detail B**).
6. Install the 14 LGX 12" cable retainer brackets (**Item 9**) on the mtg holes in the rack using 28 (2 ea. Bracket kit) 12-24 x 3/8 pan head machine screws found in hardware kit (**part # 2126490110**) as shown in (**Detail A**). These brackets can be installed in any location on the mtg holes per (**Detail A**) (picture is just an example).
7. Install the 12 LGX 6.5" Duct brackets (**Item 11**) using 24 (2 ea. Bracket) 12-24 x 3/8 pan head machine screws found in hardware kit (**part # 2126490110**) as shown in (detail c).
8. Install the left & right side panels (**Items 12 & 13**) using 12 (6 ea. Side panel) 12-24 x 1/2 pan head machine screws, 12 (6 ea. Side panel) no. 12 Plain washers and 12 (6 ea. Side panel) 12-24 heavy hex nuts found in hardware kit (**part # 2126490110**) as shown in the picture on the left.
9. Install the two LGX frame braces (**Item 10**) to the side panels using 8 (4 ea. Brace) 12-24 x 3/8 pan head machine screws found in hardware kit (**part # 2126490110**) as shown in the picture on the left.

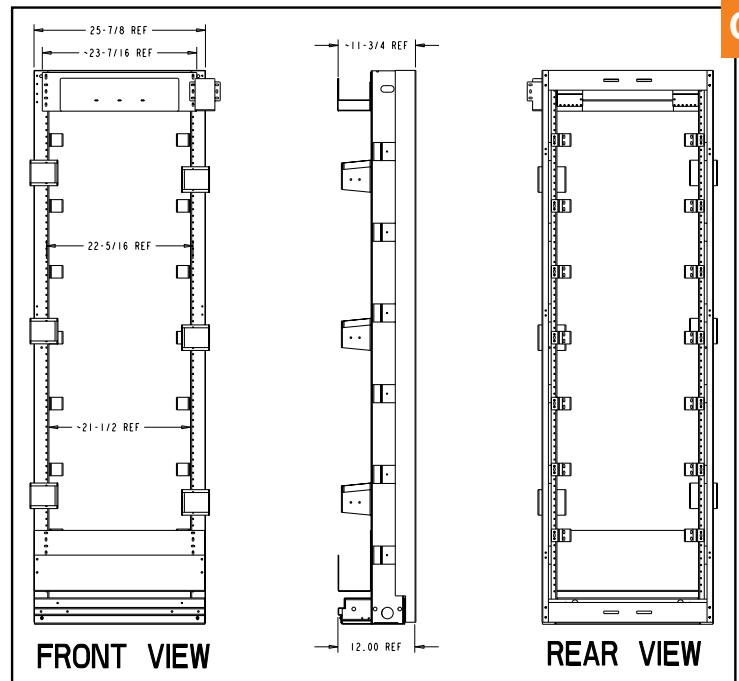

15" LGX FOT RACK KIT

Modified:09/23/2009

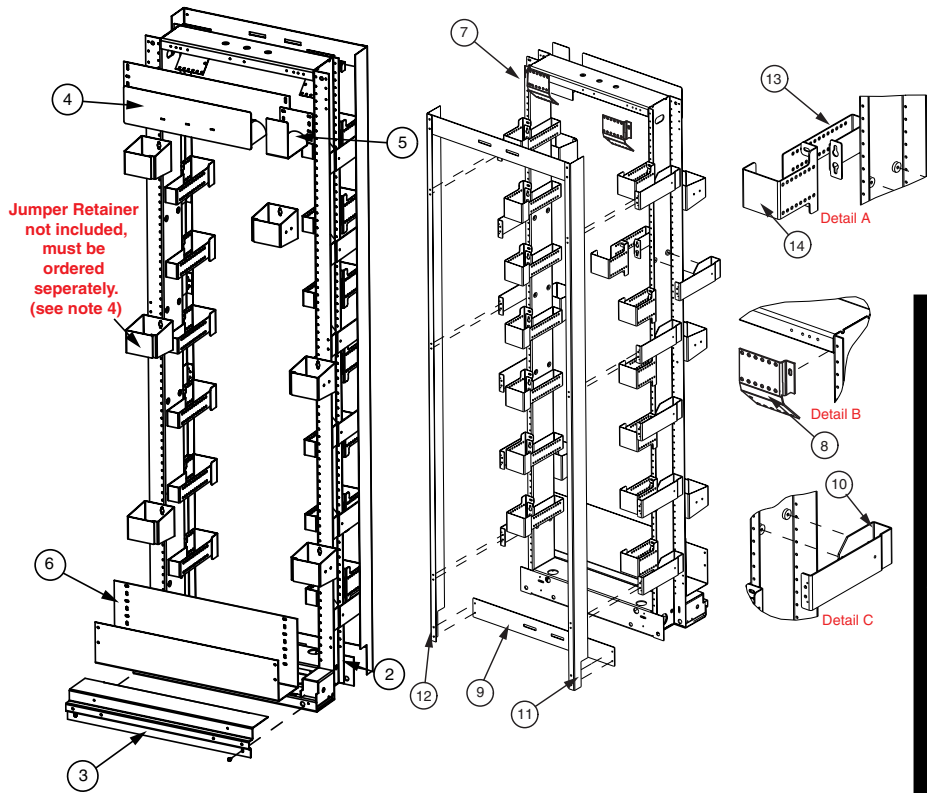

	part number	foot print
Ordering Table	2223460164	15"

Item	Qty	Description
1	1	fiber cable management kit
2	1	7' x 23" netbay, closed, 1" mtg.
3	1	5" front guard rail kit
4	1	upper raceway
5	1	jumper support
6	1	lower raceway
7	1	cable retainer bracket , left
8	1	cable retainer bracket , right
9	2	LGX frame brace
10	12	LGX 9.5" duct bracket
11	1	side panel, left side
12	1	side panel, right side
13	14	LGX 15" cable retainer In Bkt
14	14	LGX 15" cable retainer Ot Bkt

Assembly Notes:

C11

1. Install front guard rail cover (Item 3) to front of rack using the (2) 12-24 x 3/8 tri-lobe screws found in the kit as shown in the picture.
2. Install the lower raceway (Item 6) using 6 (3 ea. side) 12-24 x 3/8 pan head machine screws found in hardware kit (Item 1) as shown in the picture.
3. Install the upper raceway (Item 4) using 6 (3 ea. side) 12-24 x 3/8 pan head machine screws found in hardware kit (Item 1) as shown in the picture. The jumper support (Item 5) can be installed as an extension to the upper raceway.
4. The jumper retainers (part #, single shown 21231300xx, double 21231302xx) must be ordered separately as an accessory item. If ordered, install the jumper retainers using (2) 12-24 x 3/8 pan head machine screws as shown in the picture. The jumper retainers can be installed in any location using the mtg. Holes on the rack (the picture is just an example).
5. Install the left & right cable retainer bracket assemblies (Items 7 & 8) to the rack using 4 (2 ea. side) 12-24 x 3/8 pan head machine screws found in hardware kit (part # 2126490110) as shown in (Detail B).
6. Install the 14 LGX 15" cable retainer brackets (Items 13 & 14) on the mtg holes in the rack using 28 (2 ea. Bracket kit) 12-24 x 3/8 pan head machine screws found in hardware kit (part # 2126490110) as shown in (Detail A). These brackets can be installed in any location on the mtg holes per (Detail A) (picture is just an example).
7. Install the 12 LGX 9.5" Duct brackets (Item 10) using 24 (2 ea. Bracket) 12-24 x 3/8 pan head machine screws found in hardware kit (part # 2126490110) as shown in (detail c).
8. Install the left & right side panels (Items 11 & 12) using 12 (6 ea. Side panel) 12-24 x 1/2 pan head machine screws, 12 (6 ea. Side panel) no. 12 Plain washers and 12 (6 ea. Side panel) 12-24 heavy hex nuts found in hardware kit (part # 2126490110) as shown in the picture on the left.
9. Install the two LGX frame braces (Item 9) to the side panels using 8 (4 ea. Brace) 12-24 x 3/8 pan head machine screws found in hardware kit (part # 2126490110) as shown in the picture on the left.

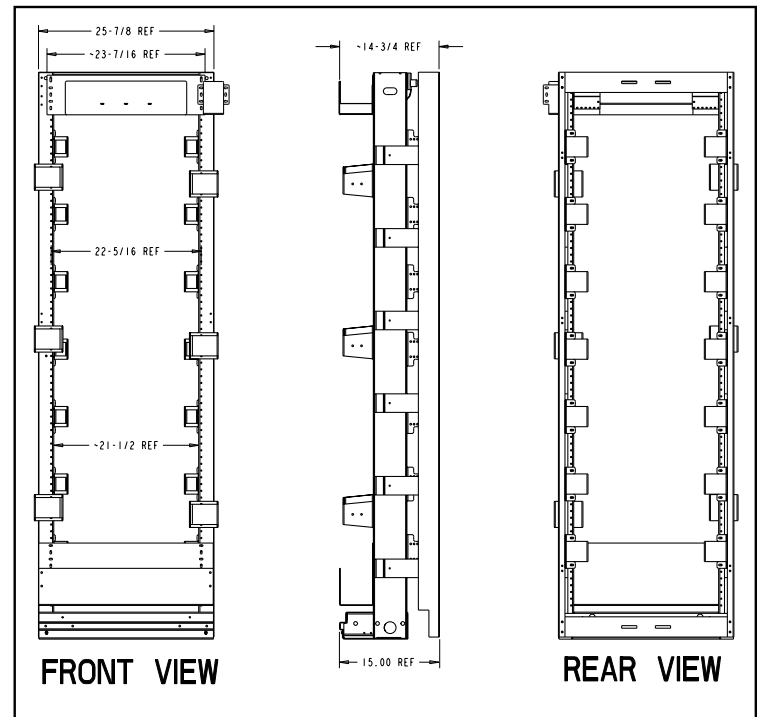

12" LGX OSP RACK KIT

Modified:09/23/2009

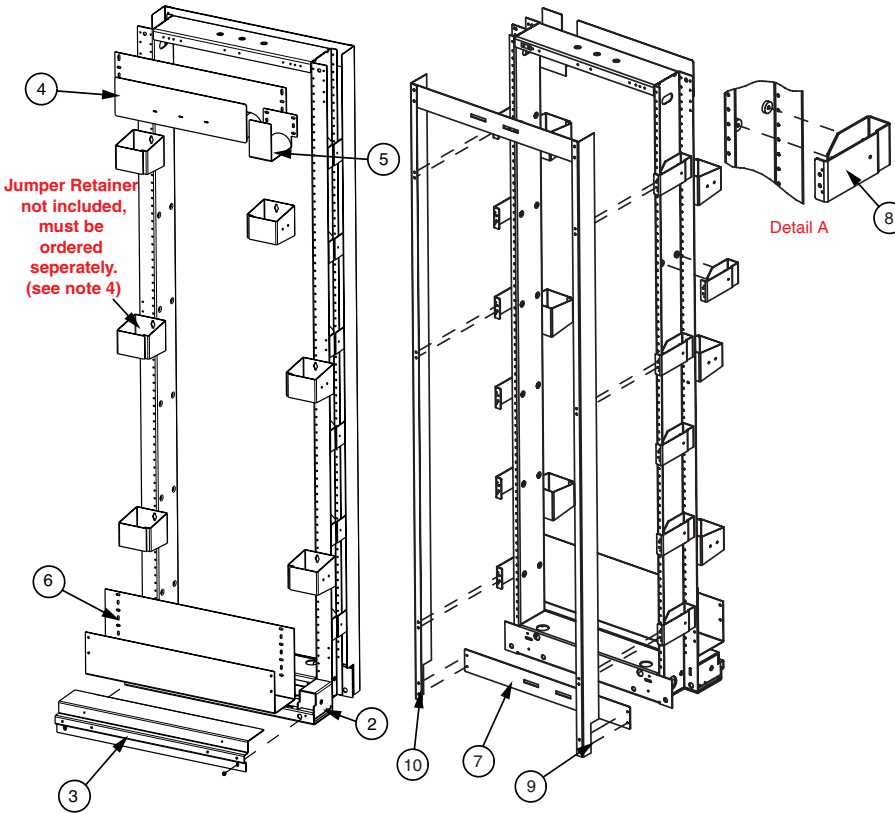

	part number	foot print
Ordering Table	2223461064	12"

	Item	Qty	Description
Stock List	1	1	fiber cable management kit
	2	1	7' x 23" netbay, closed, 1" mtg.
	3	1	5" front guard rail kit
	4	1	upper raceway
	5	1	jumper support
	6	1	lower raceway
	7	2	LGX frame brace
	8	12	LGX 6.5" duct bracket
	9	1	side panel, left side
	10	1	side panel, right side

Assembly notes:

1. Install front guard rail cover (**Item 3**) to front of rack using the (2) 12-24 x 3/8 tri-lobe screws found in the kit as shown in the picture.
2. Install the lower raceway (**Item 6**) using 6 (3 ea. side) 12-24 x 3/8 pan head machine screws found in hardware kit (**Item 1**) as shown in the picture.
3. Install the upper raceway (**Item 4**) using 6 (3 ea. side) 12-24 x 3/8 pan head machine screws found in hardware kit (**Item 1**) as shown in the picture. The jumper support (**Item 5**) can be installed as an extension to the upper raceway.
4. The jumper retainers (part #, **single shown 21231300xx, double 21231302xx**) must be ordered separately as an accessory item. If ordered, install the jumper retainers using (2) 12-24 x 3/8 pan head machine screws as shown in the picture. The jumper retainers can be installed in any location using the mtg. Holes on the rack (the picture is just an example).
5. Install the 12 LGX 6.5" Duct brackets (**Item 8**) using 24 (2 ea. Bracket) 12-24 x 3/8 pan head machine screws found in hardware kit (**part # 2126490110**) as shown in (**Detail A**).
6. Install the left & right side panels (**Items 9 & 10**) using 12 (6 ea. Side panel) 12-24 x 1/2 pan head machine screws, 12 (6 ea. Side panel) no. 12 Plain washers and 12 (6 ea. Side panel) 12-24 heavy hex nuts found in hardware kit (**part # 2126490110**) as shown in the picture on the left.

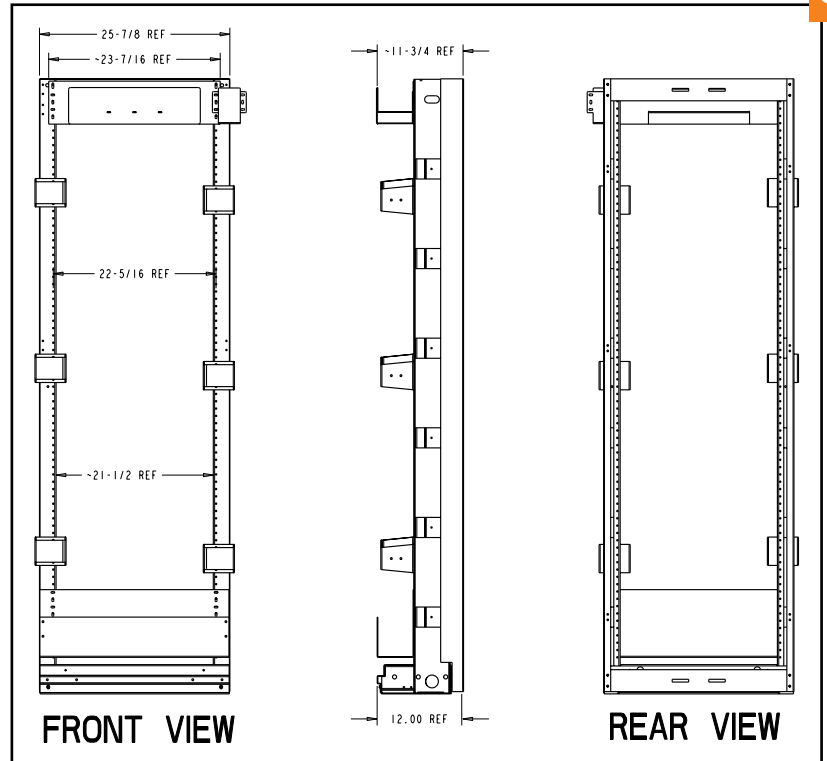

C11

7. Install the two LGX frame braces (**Item 7**) to the side panels using 8 (4 ea. Brace) 12-24 x 3/8 pan head machine screws found in hardware kit (**part # 2126490110**) as shown in the picture on the left.

15" LGX OSP RACK KIT

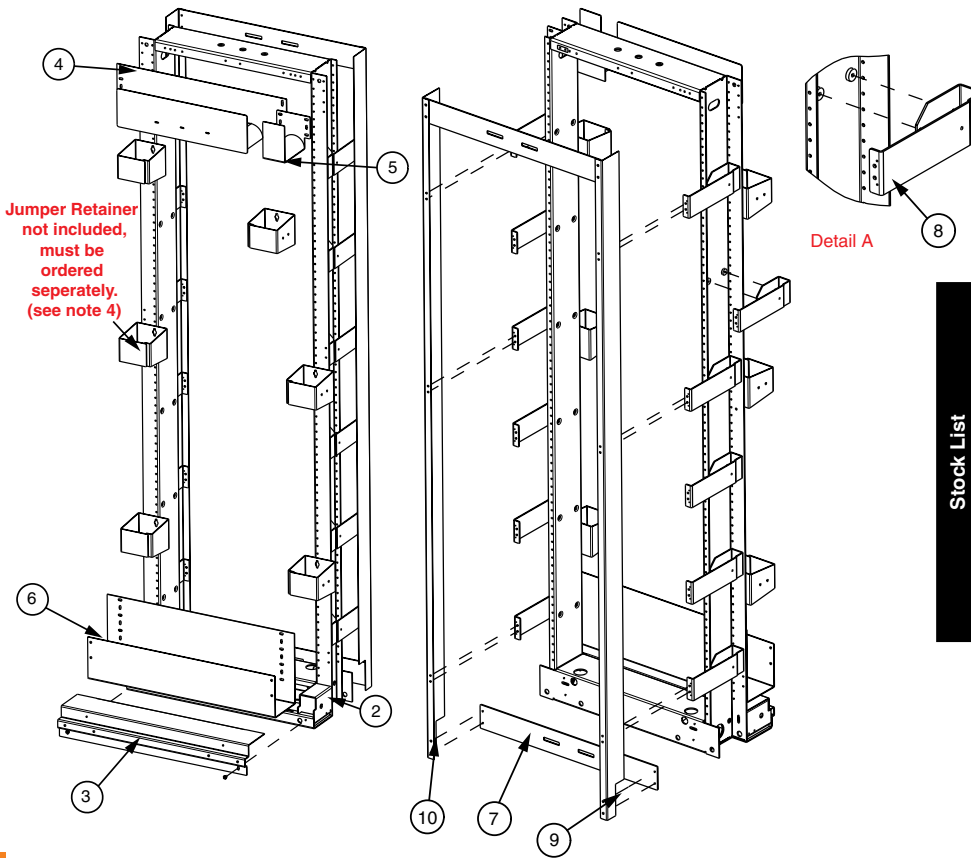

	part number	foot print
Ordering Table	2223461164	15"

	Item	Qty	Description
Stock List	1	1	fiber cable management kit
	2	1	7' x 23" netbay, closed, 1" mtg.
	3	1	5" front guard rail kit
	4	1	upper raceway
	5	1	jumper support
	6	1	lower raceway
	7	2	LGX frame brace
	8	12	LGX 9.5" duct bracket
	9	1	side panel, left side
	10	1	side panel, right side

C11

Assembly notes:

1. Install front guard rail cover (**Item 3**) to front of rack using the (2) 12-24 x 3/8 tri-lobe screws found in the kit as shown in the picture.
2. Install the lower raceway (**Item 6**) using 6 (3 ea. side) 12-24 x 3/8 pan head machine screws found in hardware kit (**Item 1**) as shown in the picture.
3. Install the upper raceway (**Item 4**) using 6 (3 ea. side) 12-24 x 3/8 pan head machine screws found in hardware kit (**Item 1**) as shown in the picture. The jumper support (**Item 5**) can be installed as an extension to the upper raceway.
4. The jumper retainers (part #, **single shown 21231300xx, double 21231302xx**) must be ordered separately as an accessory item. If ordered, install the jumper retainers using (2) 12-24 x 3/8 pan head machine screws as shown in the picture. The jumper retainers can be installed in any location using the mtg. Holes on the rack (the picture is just an example).
5. Install the 12 LGX 9.5" Duct brackets (**Item 2**) using 24 (2 ea. Bracket) 12-24 x 3/8 pan head machine screws found in hardware kit (**part # 2126490110**) as shown in (**Detail A**).
6. Install the left & right side panels (**Items 3 & 4**) using 12 (6 ea. Side panel) 12-24 x 1/2 pan head machine screws, 12 (6 ea. Side panel) no. 12 Plain washers and 12 (6 ea. Side panel) 12-24 heavy hex nuts found in hardware kit (**part # 2126490110**) as shown in the picture on the left.

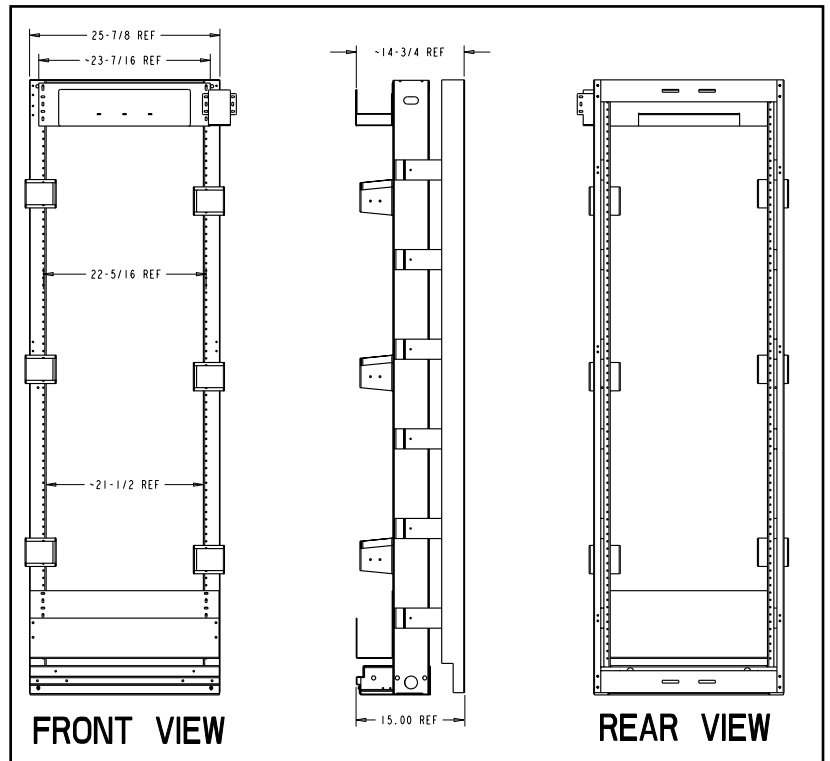

7. Install the two LGX frame braces (**Item 1**) to the side panels using 8 (4 ea. Brace) 12-24 x 3/8 pan head machine screws found in hardware kit (**part # 2126490110**) as shown in the picture on the left..

SEISMIC 12" LGX FOT RACK KIT

Modified:09/23/2009

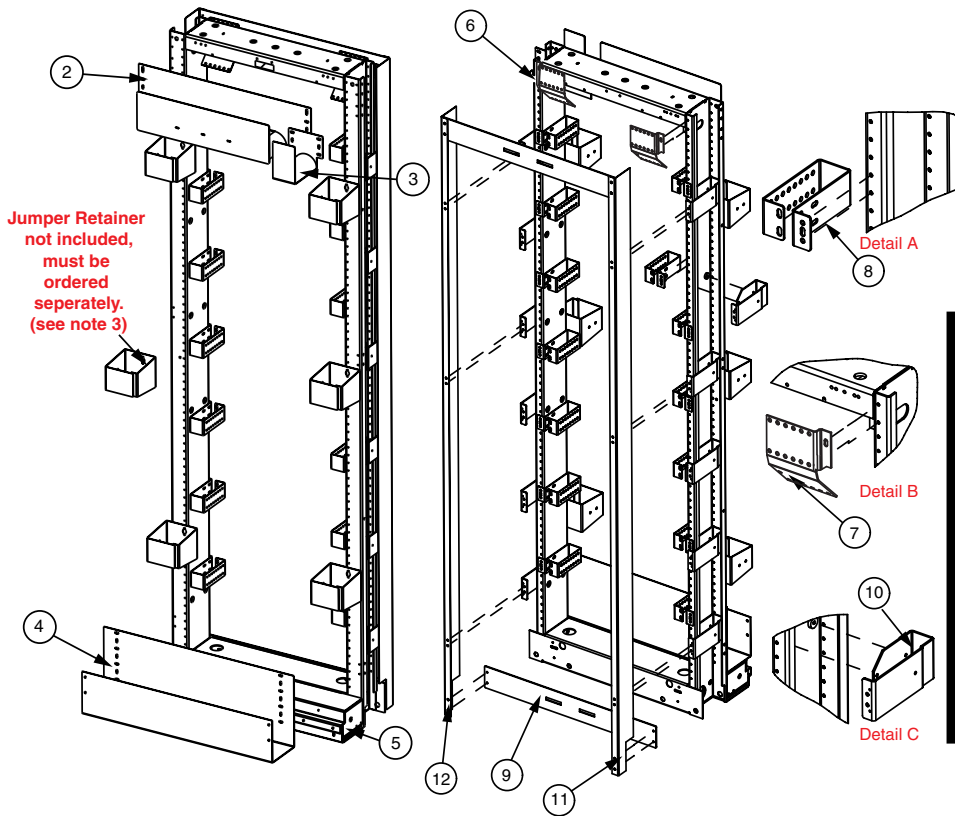

	part number	foot print
Ordering Table	2223640064	12"

Item	Qty	Description
1	1	fiber cable management kit
2	1	upper raceway
3	1	jumper support
4	1	lower raceway
5	1	7' x 23" netbay, closed, 1" mtg.
6	1	cable retainer bracket , left
7	1	cable retainer bracket , right
8	14	LGX 12" cable retainer bracket
9	2	LGX frame brace
10	12	LGX 6.5" duct bracket
11	1	side panel, left side
12	1	side panel, right side

Assembly Notes:

1. Install the lower raceway (Item 4) using 6 (3 ea. side) 12-24 x 3/8 pan head machine screws found in hardware kit (Item 1) as shown in the picture.
2. Install the upper raceway (Item 2) using 6 (3 ea. side) 12-24 x 3/8 pan head machine screws found in hardware kit (Item 1) as shown in the picture. The jumper support (Item 3) can be installed as an extension to the upper raceway.
3. The jumper retainers (part #, single shown 21231300xx, double 21231302xx) must be ordered separately as an accessory item. If ordered, install the jumper retainers using (2) 12-24 x 3/8 pan head machine screws as shown in the picture. The jumper retainers can be installed in any location using the mtg. Holes on the rack (the picture is just an example).
4. Install the left & right cable retainer bracket assemblies (Items 6 & 7) to the rack using 4 (2 ea. Side) 12-24 x 3/8 pan head machine screws found in hardware kit (part # 2126490110) as shown in (Detail B).
5. Install the 14 LGX 12" cable retainer brackets (Item 8) on the mtg holes in the rack using 28 (2 ea. Bracket kit) 12-24 x 3/8 pan head machine screws found in hardware kit (part # 2126490110) as shown in (Detail A). These brackets can be installed in any location on the mtg holes per (Detail A)
6. Install the 12 LGX 6.5" Duct brackets (Item 10) using 24 (2 ea. Bracket) 12-24 x 3/8 pan head machine screws found in hardware kit (part # 2126490110) as shown in (detail c).
7. Install the left & right side panels (Items 6 & 7) using 12 (6 ea. Side panel) 12-24 x 1/2 pan head machine screws, 12 (6 ea. Side panel) no. 12 Plain washers and 12 (6 ea. Side panel) 12-24 heavy hex nuts found in hardware kit (part # 2126490110) as shown in the picture.
8. Install the two LGX frame braces (Item 9) to the side panels using 8 (4 ea. brace) 12-24 x 3/8 pan head machine screws found in hardware kit (part # 2126490110) as shown in the picture on the left.

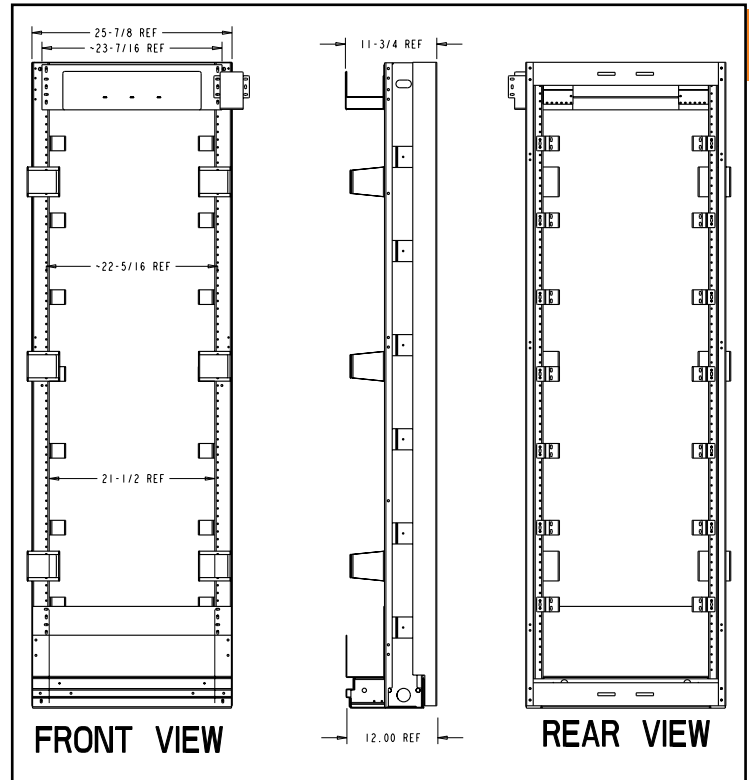

SEISMIC 15" LGX FOT RACK KIT

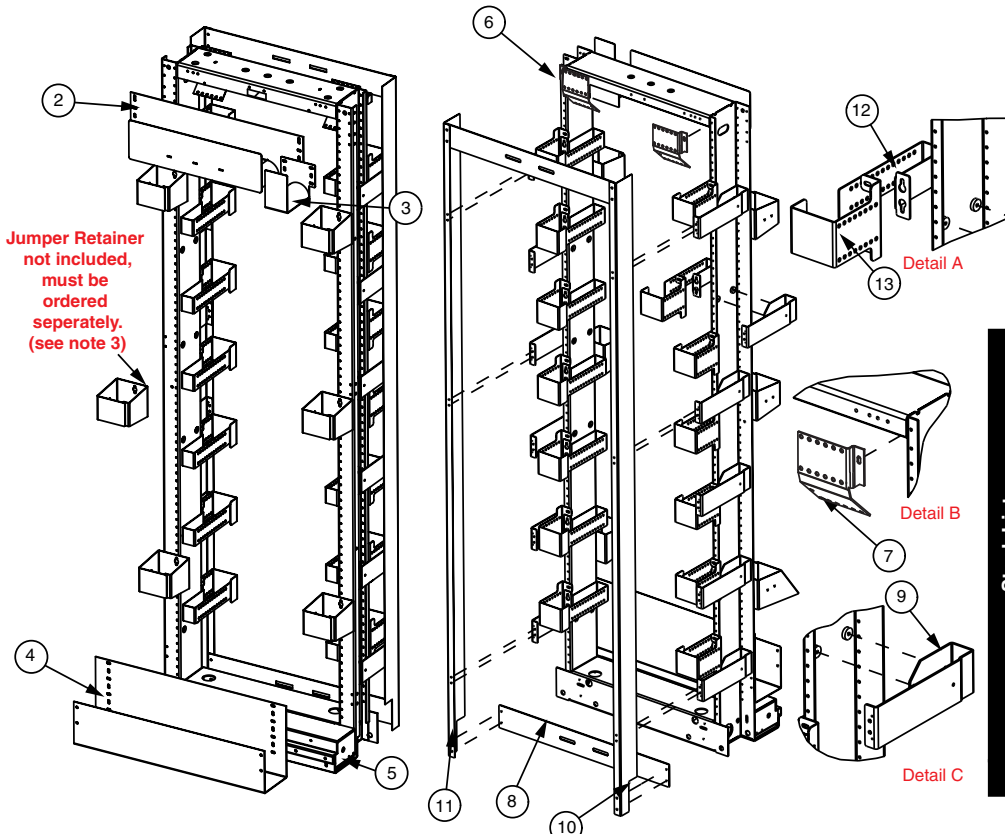

	part number	foot print
Ordering Table	2223640164	15"

	Item	Qty	Description
Stock List	1	1	fiber cable management kit
	2	1	upper raceway
	3	1	jumper support
	4	1	lower raceway
	5	1	7' x 23" netbay, closed, 1" mtg.
	6	1	cable retainer bracket , left
	7	1	cable retainer bracket , right
	8	2	LGX frame brace
	9	12	LGX 9.5" duct bracket
	10	1	side panel, left side
	11	1	side panel, right side
	12	14	LGX 15" cable retainer in bkt
	13	14	LGX 15" cable retainer ot bkt

Assembly Notes:

1. Install the lower raceway (Item 4) using 6 (3 ea. side) 12-24 x 3/8 pan head machine screws found in hardware kit (Item 1) as shown in the picture.
2. Install the upper raceway (Item 4) using 6 (3 ea. side) 12-24 x 3/8 pan head machine screws found in hardware kit (Item 1) as shown in the picture. The jumper support (Item 3) can be installed as an extension to the upper raceway.
3. The jumper retainers (part #, **single shown 21231300xx, double 21231302xx**) must be ordered separately as an accessory item. If ordered, install the jumper retainers using (2) 12-24 x 3/8 pan head machine screws as shown in the picture. The jumper retainers can be installed in any location using the mtg. Holes on the rack (the picture is just an example).
4. Install the left & right cable retainer bracket assemblies (Items 6 & 7) to the rack using 4 (2 ea. side) 12-24 x 3/8 pan head machine screws found in hardware kit (part # 2126490110) as shown in (Detail B).
5. Install the 14 LGX 15" cable retainer brackets (Items 12 & 13) on the mtg holes in the rack using 56 (4 ea. Bracket kit) 2-24 x 3/8 pan head machine screws found in hardware kit (part # 2126490110) as shown in (Detail A). These brackets can be installed in any location on the mtg holes per (Detail A) (picture is just an example).
6. Install the 12 LGX 9.5" Duct brackets (Item 9) using 24 (2 ea. Bracket) 12-24 x 3/8 pan head machine screws found in hardware kit (part # 2126490110) as shown in (detail c).
7. Install the left & right side panels (Items 10 & 11) using 12 (6 ea. Side panel) 12-24 x 1/2 pan head machine screws, 12 (6 ea. Side panel) no. 12 Plain washers and 12 (6 ea. Side panel) 12-24 heavy hex nuts found in hardware kit (part # 2126490110) as shown in the picture.
8. Install the two LGX frame braces (Item 8) to the side panels using 8 (4 ea. Brace) 12-24 x 3/8 pan head machine screws found in hardware kit (part # 2126490110) as shown in the picture.

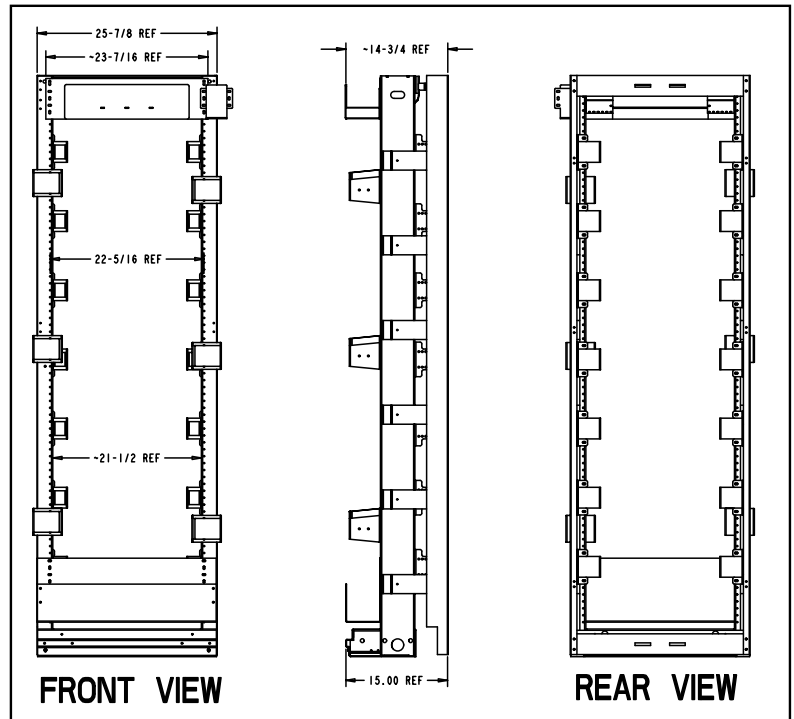

SEISMIC 12" LGX OSP RACK KIT

Modified:09/23/2009

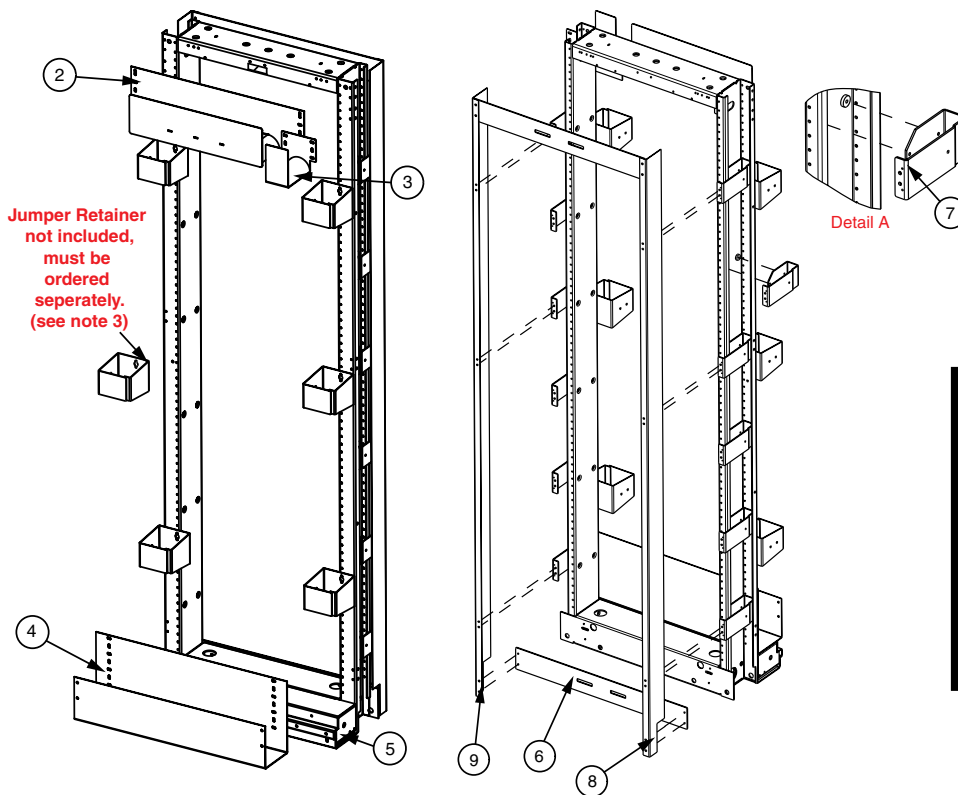

	part number	foot print
Ordering Table	2223641064	12"

	Item	Qty	Description
Stock List	1	1	fiber cable management kit
	2	1	upper raceway
	3	1	jumper support
	4	1	lower raceway
	5	1	7' x 23" netbay, closed, 1" mtg.
	6	2	LGX frame brace
	7	12	LGX 6.5" duct bracket
	8	1	side panel, left side
	9	1	side panel, right side

Assembly notes:

1. Install the lower raceway (Item 4) using 6 (3 ea. side) 12-24 x 3/8 pan head machine screws found in hardware kit (Item 1) as shown in the picture.
2. Install the upper raceway (Item 2) using 6 (3 ea. side) 12-24 x 3/8 pan head machine screws found in hardware kit (Item 1) as shown in the picture. The jumper support (Item 3) can be installed as an extension to the upper raceway.
3. The jumper retainers (part #, **single shown 21231300xx, double 21231302xx**) must be ordered separately as an accessory item. If ordered, install the jumper retainers using (2) 12-24 x 3/8 pan head machine screws as shown in the picture. The jumper retainers can be installed in any location using the mtg. Holes on the rack (the picture is just an example).
4. Install the 12 LGX 6.5" Duct brackets (Item 7) using 24 (2 ea. Bracket) 12-24 x 3/8 pan head machine screws found in hardware kit (part # 2126490110) as shown in (Detail A).
5. Install the left & right side panels (Items 8 & 9) using 12 (6 ea. Side panel) 12-24 x 1/2 pan head machine screws, 12 (6 ea. Side panel) no. 12 Plain washers and 12 (6 ea. Side panel) 12-24 heavy hex nuts found in hardware kit (part # 2126490110) as shown in the picture on the left.
6. Install the two LGX frame braces (Item 6) to the side panels using 8 (4 ea. Brace) 12-24 x 3/8 pan head machine screws found in hardware kit (part # 2126490110) as shown in the picture on the left.

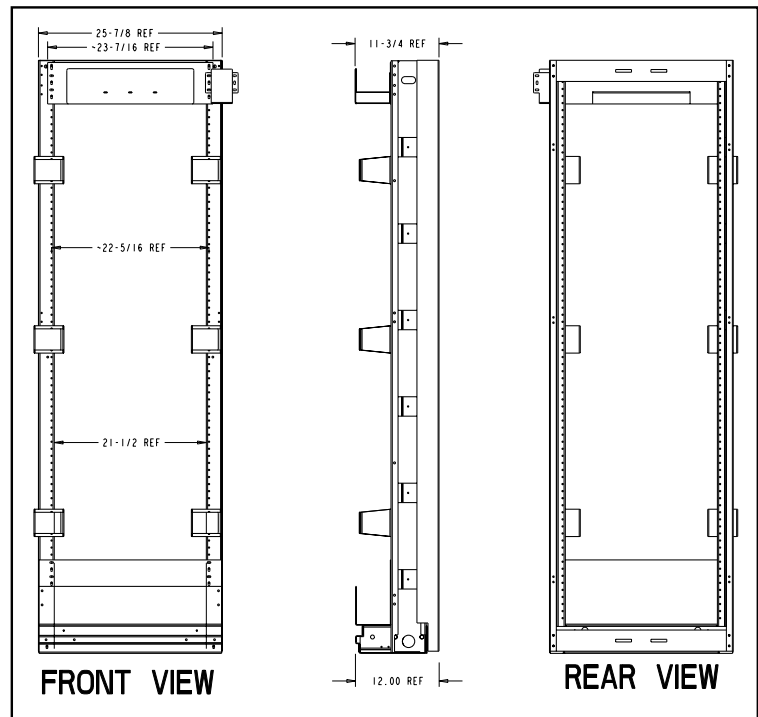

C11

SEISMIC 15" LGX OSP RACK KIT

Modified:09/23/2009

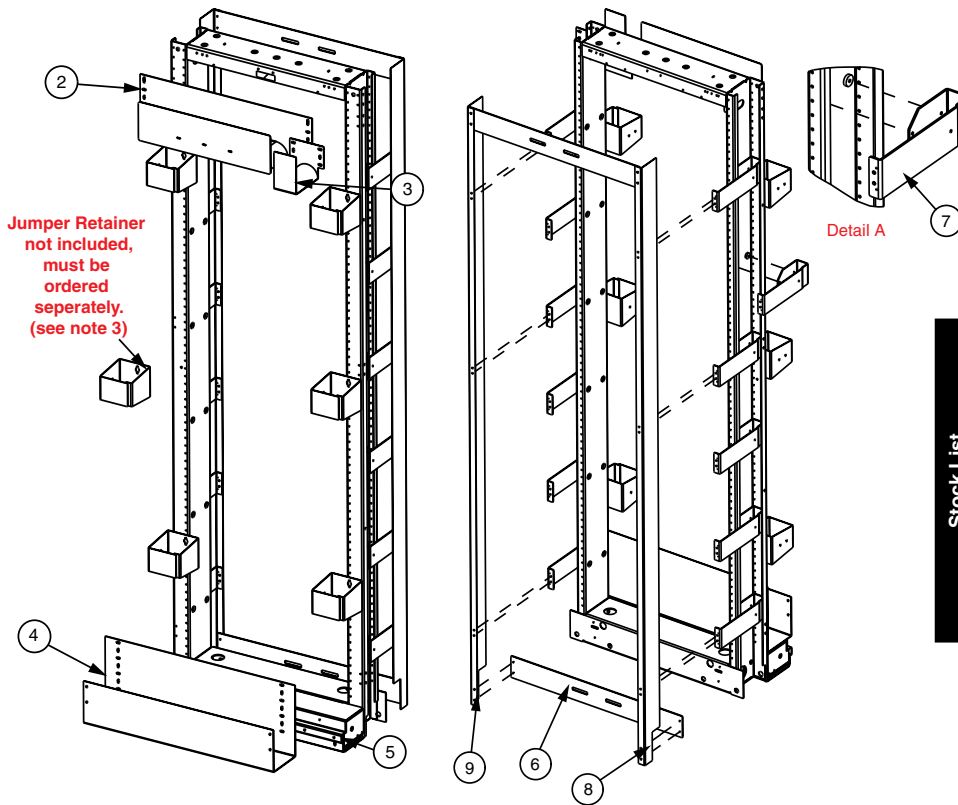

	part number	foot print
Ordering Table	2223641164	15"

	Item	Qty	Description
Stock List	1	1	fiber cable management kit
	2	1	upper raceway
	3	1	jumper support
	4	1	lower raceway
	5	1	7' x 23" netbay, closed, 1" mtg.
	6	2	LGX frame brace
	7	12	LGX 9.5" duct bracket
	8	1	side panel, left side
	9	1	side panel, right side

Assembly Notes:

C11

1. Install the lower raceway (Item 4) using 6 (3 ea. side) 12-24 x 3/8 pan head machine screws found in hardware kit (Item 1) as shown in the picture.
2. Install the upper raceway (Item 2) using 6 (3 ea. side) 12-24 x 3/8 pan head machine screws found in hardware kit (Item 1) as shown in the picture. The jumper support (Item 3) can be installed as an extension to the upper raceway.
3. The jumper retainers (part #, **single shown 21231300xx, double 21231302xx**) must be ordered separately as an accessory item. If ordered, install the jumper retainers using (2) 12-24 x 3/8 pan head machine screws as shown in the picture. The jumper retainers can be installed in any location using the mtg. Holes on the rack (the picture is just an example).
4. Install the 12 LGX 9.5" Duct brackets (Item 7) using 24 (2 ea. Bracket) 12-24 x 3/8 pan head machine screws found in hardware kit (part # 2126490110) as shown in (Detail A).
5. Install the left & right side panels (Items 8 & 9) using 12 (6 ea. Side panel) 12-24 x 1/2 pan head machine screws, 12 (6 ea. Side panel) no. 12 Plain washers and 12 (6 ea. Side panel) 12-24 heavy hex nuts found in hardware kit (part # 2126490110) as shown in the picture on the left.
6. Install the two LGX frame braces (Item 6) to the side panels using 8 (4 ea. Brace) 12-24 x 3/8 pan head machine screws found in hardware kit (part # 2126490110) as shown in the picture on the left.

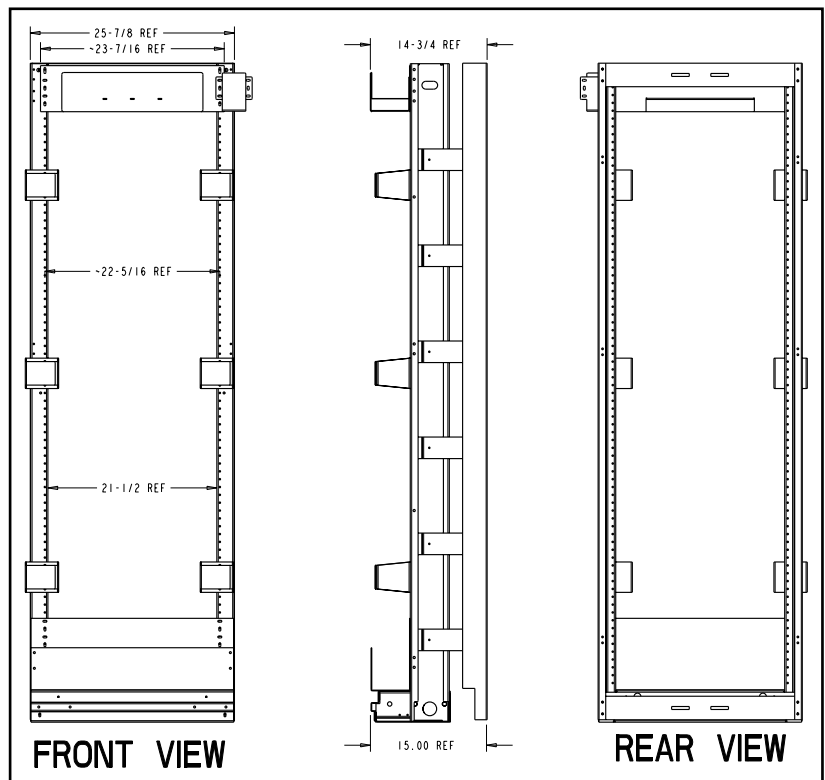

JUMPER RETAINER

Modified:02/15/2012

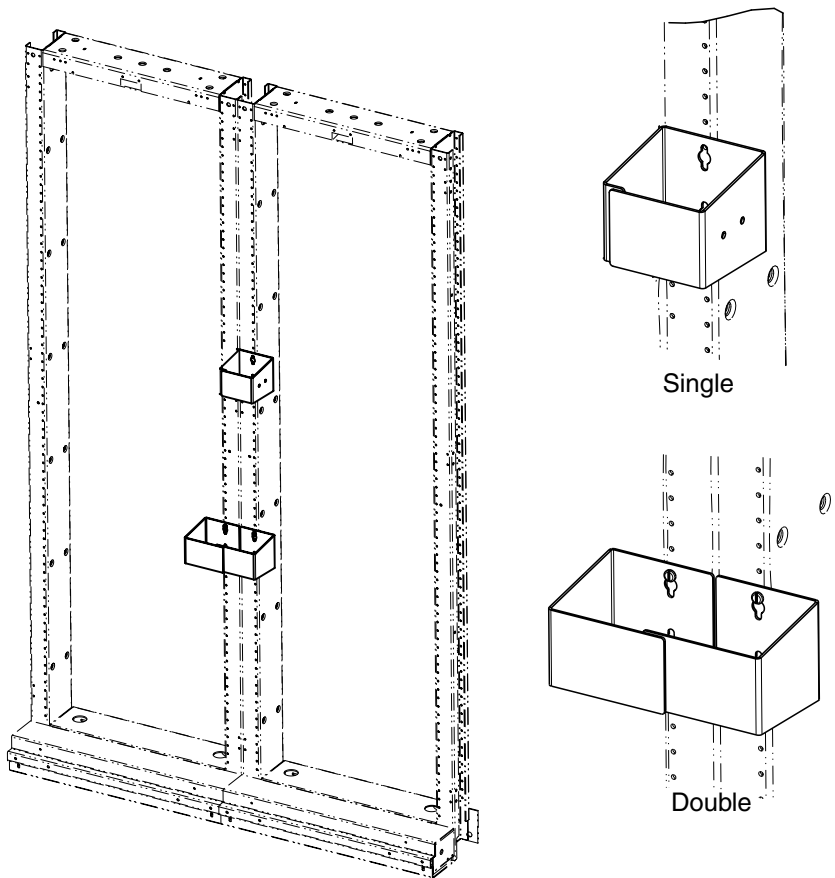

Ordering Table	Part Number	Finish
	2123130064	network blue
	212313009c	putty white

Stock List	Item	Qty	Description
	1	2	12-24 x 3/8" PHMS
	2	1	jumper retainer

Ordering Table	Part Number	Finish
	2123130264	network blue
	2123130264	putty white

Stock List	Item	Qty	Description
	1	4	12-24 x 3/8" PHMS
	2	1	double jumper retainer (short)
3	1	double jumper retainer (long)	

C11

12" LGX END GUARDS

Modified:02/15/2012

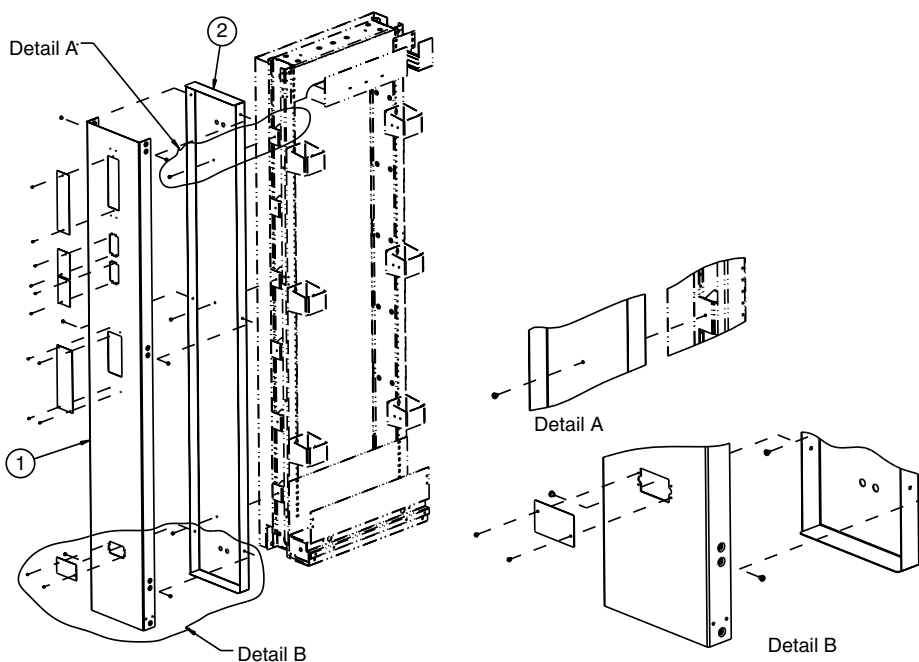

Ordering Table	Part Number	Height
	22281200xx	7'

Stock List	Item	Qty	Description
	1	1	end cover
	2	1	end cover box
3	ar	LGX end guard hardware kit	

DSX FRAME KIT

Modified:10/12/2016

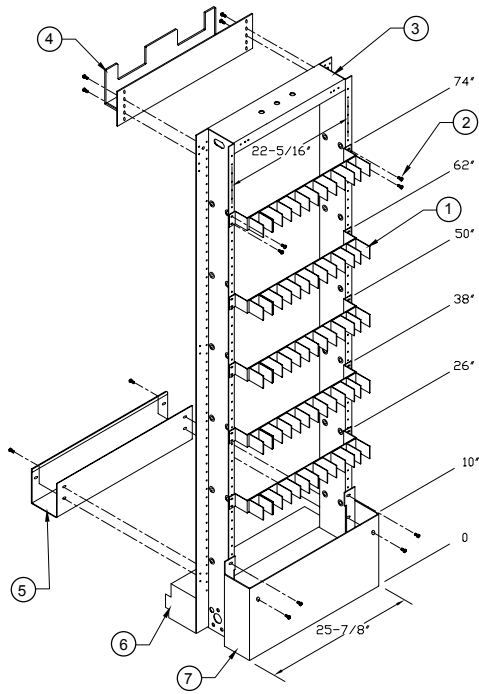

	part number	length
Ordering Table	21374100xx	2'

	Item	Qty	Description
Stock List	1	5	cable retainer
	2	60	12-24 x 1/4 phms
	3	1	network bay
	4	1	upper cable trough
	5	2	lower cable trough
	6	1	front guard rail kit
	7	1	rear cover

RACK SPACE DESIGNATION STRIP

Modified:06/03/2015

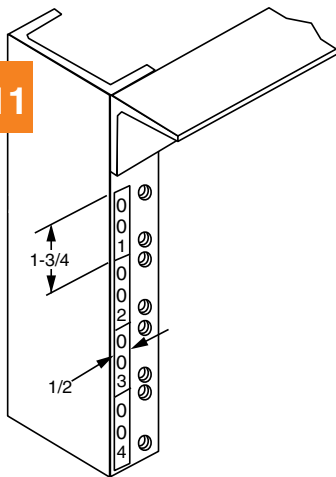

Ordering Table

Part Number	Orientation
0040790000	Top To Bottom
2113920000	Bottom To Top

Notes:

- One roll contains 5 strips with fifteen designations per strip that are numbered from 001 to 075.
- Black numbers on clear mylar.

NAME PLATE

Modified:09/28/2009

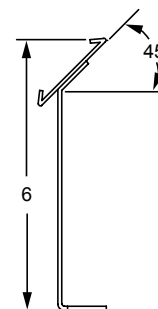
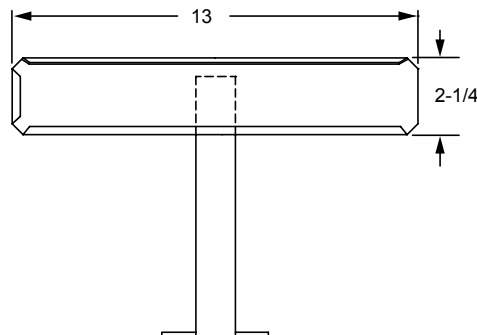
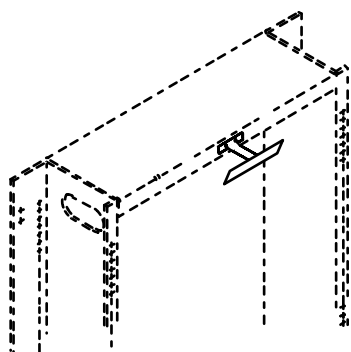

	part number
Ordering Table	21269400xx